

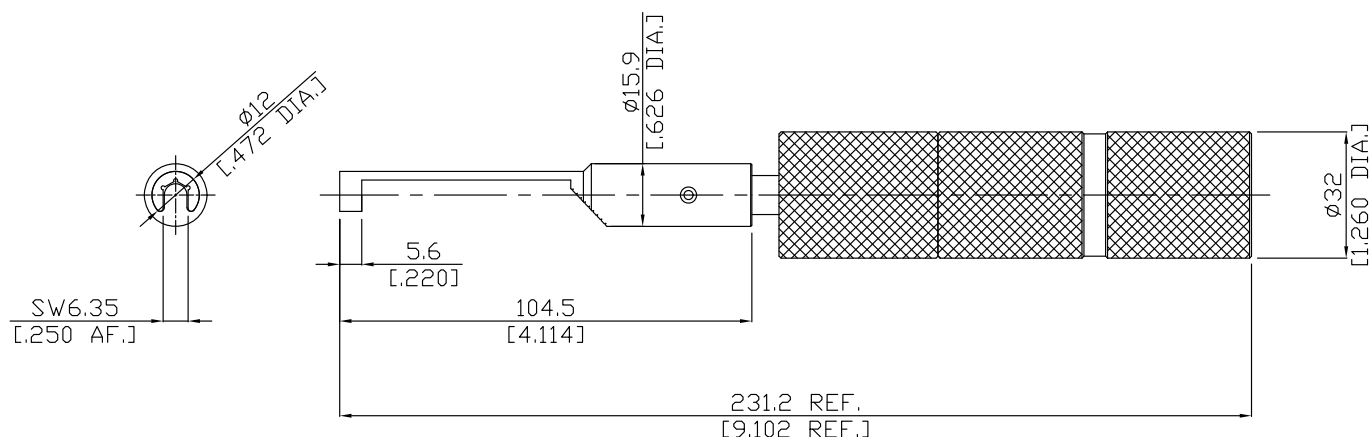

Torque Wrench Screwdriver Type
6.35 mm (.250 inch) Bit Pre-set to 0.57 N.m. (5 in-lbs) for SSMA Brass Body

RN-RTW-SD-6.35-5A



All dimensions are in mm [inch]
Tolerances according to DIN ISO 2768-mH

Suitable connector

SSMA Brass

Material And Plating

Tooling parts	Material	Plating
Spanner	Tool Steel	Passivated
Handle	Aluminum	Anodized

Mechanical data

Width across flats	6.35 mm [.250 inch]
Torque setting	5 lb-in \pm 0.5lb-in [0.57 Nm \pm 0.06 Nm]

Packing

1 Pcs