

2.4mm Termination with Chain DC-40GHz VSWR1.15

T-Q15-50G30WA / 9XX

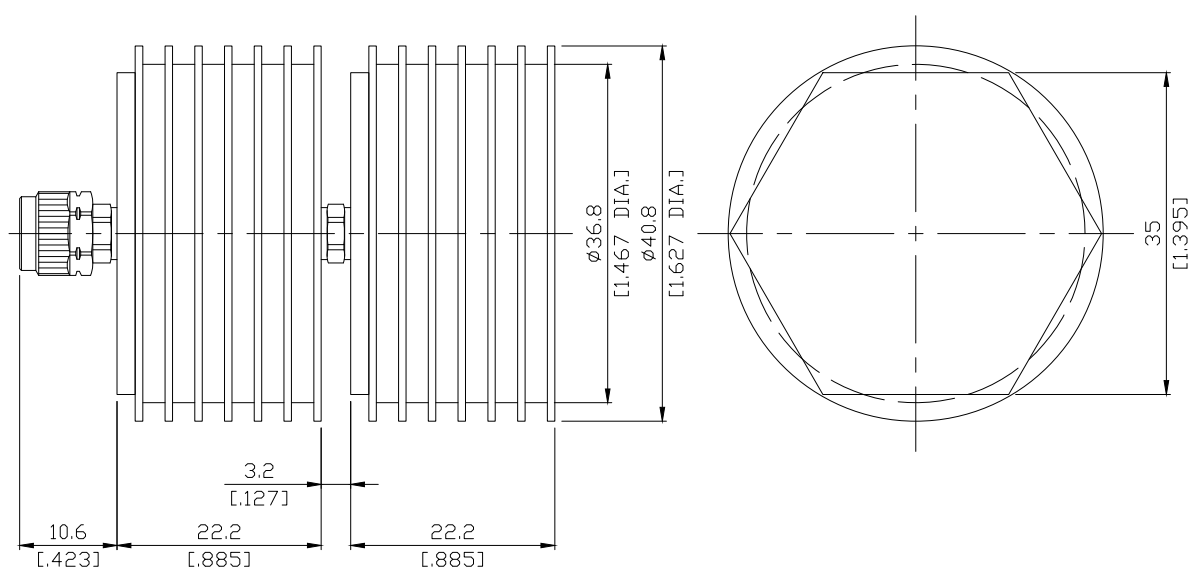

All dimensions are in mm [inch]

Tolerances according to DIN ISO 2768-mH

Interface

According to

IEEE-Std-287

IEC 61169-40

Electrical Data

Impedance

50 Ω

Frequency

DC to 50 GHz

VSWR (Return Loss)

≤ 1.5 (≥ 14 dB)

Power rating (Watt)

30 W

Material And Plating

Piece Parts	Material	Plating
Centre contact	Brass	Gold plating, 3 μinch (Non-magnetic nickel-phosphorus underplating, 80 μinch)
Body	Stainless Steel	Passivated
Insulator	PS	
Coupling nut	Stainless Steel	Passivated

2.4mm Termination with Chain DC-40GHz VSWR1.15

T-Q15-50G30WA / 9XX

Mechanical Data

Coupling Mechanisms	Screw-Lock
Mating Cycles	≥ 500
Center Contact Captivation: axial	≥ 22 N
Coupling Test Torque	≤ 1.7 Nm
Recommended Torque	0.8 Nm to 1.1 Nm

Environmental Data

Temperature Range	-40°C to +85°C
Thermal Shock	MIL-STD-202, Method 107, Condition B
Corrosion	MIL-STD-202, Method 101, Condition B
Vibration	MIL-STD-202, Method 204, Condition D
Shock	MIL-STD-202, Method 213, Condition I
Moisture Resistance	MIL-STD-202, Method 106
RoHS	compliant

Packing

Single or 100