

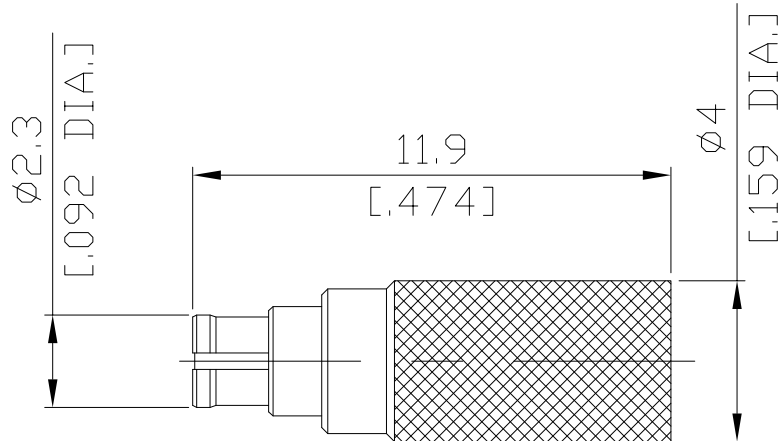

SMPM Termination Jack
40 GHz, 0.25 Watt

T-PM25-40G0.25WA/99



All dimensions are in mm [inch]

Tolerances according to DIN ISO 2768-mH

Interface

According to MIL-STD-348A/328
Mateable with GPPO™ (Gilbert Engineering Co., Inc)

Electrical Data

Impedance 50 Ω
Interface frequency max. DC to 40 GHz
VSWR (Return loss) ≤ 1.45 (≥ 14.72 dB)
Power rating (Watt) 0.25 W

Mechanical Data

Coupling mechanisms Snap-On
Weight N/A

Environmental Data

Temperature range -45°C to +125°C
RoHS compliant

Material And Plating

Connector parts	Material	Plating
Centre contact	Beryllium Copper	Gold plating(Nickel underplated)
Body	Beryllium Copper	Gold plating(Nickel underplated)
Insulator	PEI	

Packing

Single