

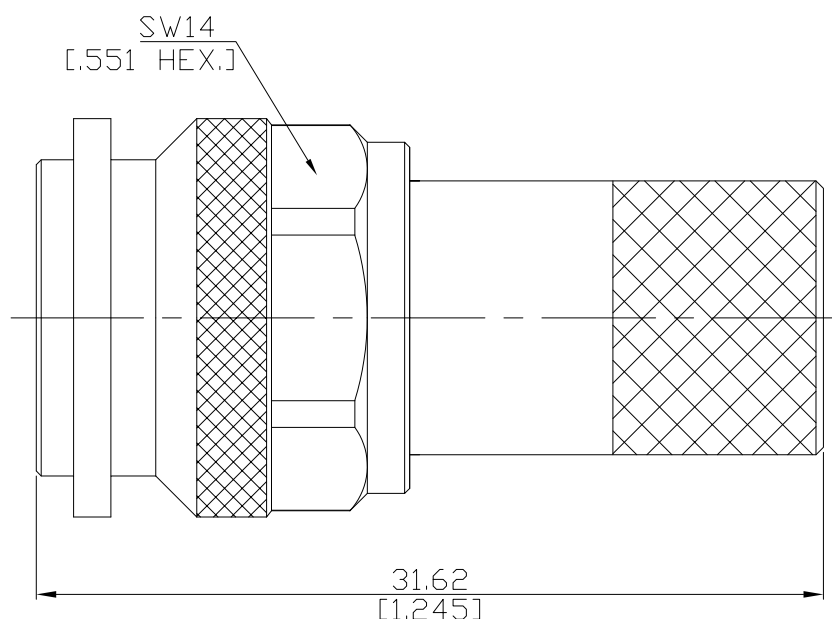

TNC Female Input 1 Watt RF Load Up to 18 GHz

T-PCT15-18G1WA / 9XX



All dimensions are in mm [inch]

Tolerances according to DIN ISO 2768-mH

Interface

According to

IEC 60169-17

MIL-STD-348B/313

Electrical Data

Impedance

50 Ω

Frequency

DC to 18 GHz

VSWR (Return Loss)

≤ 1.4 (≥ 15.6 dB)

Power rating (Watt)

50 Watts

Material And Plating

Piece Parts	Material	Plating
Centre contact	Beryllium Copper	Gold plating, 3 μ inch (Non-magnetic nickel-phosphorus underplating, 80 μ inch)
Body	Stainless Steel	Passivated
Insulator	PTFE	
Coupling nut	Stainless Steel	Passivated

TNC Female Input 1 Watt RF Load Up to 18 GHz

T-PCT15-18G1WA / 9XX

Mechanical Data

Coupling Mechanisms	Screw-Lock
Mating Cycles	≥ 500
Center Contact Captivation: axial	≥ 27 N
Coupling Test Torque	≤ 1.7 Nm
Recommended Torque	0.46 Nm to 0.69 Nm

Environmental Data

Temperature Range	-30°C to +65°C
Thermal Shock	MIL-STD-202, Method 107, Condition B
Corrosion	MIL-STD-202, Method 101, Condition B
Vibration	MIL-STD-202, Method 204, Condition B
Shock	MIL-STD-202, Method 213, Condition G
Moisture Resistance	MIL-STD-202, Method 106
RoHS	compliant

Packing

Single or 100