

100 Watt RF Load Up to 27 GHz With Precision SMA Plug (Male) Input
Black Anodized Aluminum Heatsink

T-PCA15-27G100WA / 9XX

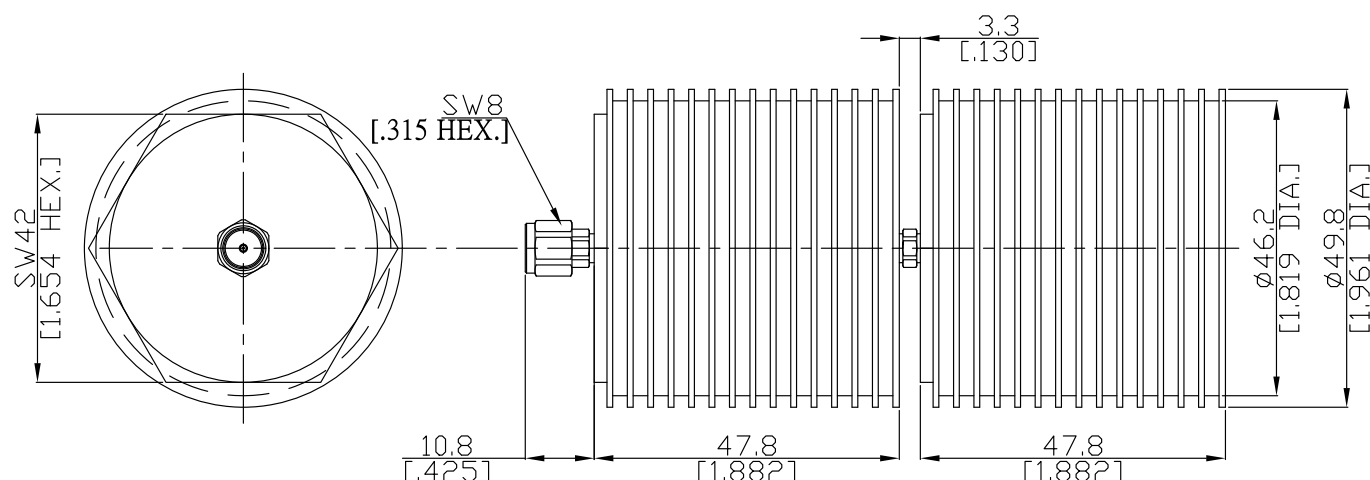

All dimensions are in mm [inch]

Tolerances according to DIN ISO 2768-mH

Interface

According to

IEC 60169-15; CECC 22110; MIL-PRF-39012 SMA; MIL-STD-348/310

Electrical Data

Impedance

50 Ω

Frequency

DC to 27 GHz

VSWR (Return Loss)

≤ 1.45 (≥ 14.72 dB)

RF Power Rating

100 Watts Average at 25°C

Material And Plating

Piece Parts	Material	Plating
Centre Contact	Beryllium Copper	Gold plating, Nickel underplated
Body	Stainless Steel	Passivated
Insulator	PTFE	
Gasket	Silicone Rubber	
Coupling Nut	Stainless Steel	Passivated
Heatsinks	Aluminum	Black anodized

100 Watt RF Load Up to 27 GHz With Precision SMA Plug (Male) Input Black Anodized Aluminum Heatsink

T-PCA15-27G100WA / 9XX

Mechanical Data

Coupling mechanisms	Screw-lock
Mating Cycles	≥ 500
Coupling Nut Retention	N/A
Center contact captivation: axial	≥ 20 N
Coupling Test Torque	1.70 Nm max.
Recommended Torque	0.8 Nm to 1.1 Nm

Environmental Data

Temperature Range	-55°C to +100°C
Thermal shock	MIL-STD-202, Method 107, Condition B
Corrosion	MIL-STD-202, Method 101, Condition B
Vibration	MIL-STD-202, Method 204, Condition D
Shock	MIL-STD-202, Method 213, Condition I
Moisture Resistance	MIL-STD-202, Method 106
RoHS	compliant

Packing

Single or 100