

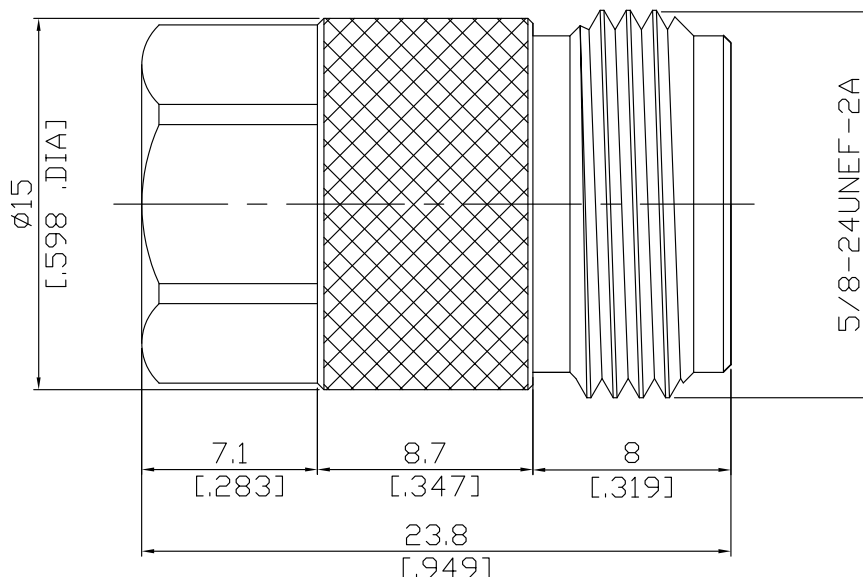

1 Watt RF Load Up to 18 GHz With N Female

## T-N25-18G1WA / H3

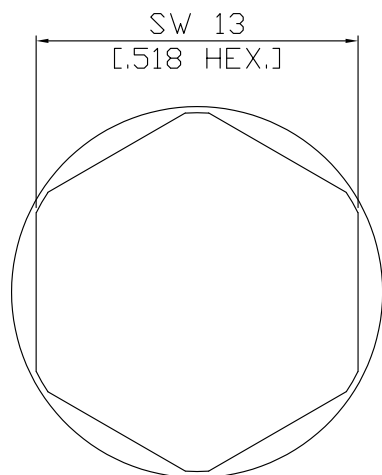

All dimensions are in mm [inch]

Tolerances according to DIN ISO 2768-mH

### Interface

According to

IEC 61169-16; MIL-STD-348A/304

### Electrical Data

Impedance

50  $\Omega$

Frequency

DC to 18 GHz

VSWR (Return Loss)

$\leq 1.25$  ( $\geq 19.08$  dB)

Insertion Loss

$\leq 0.05 \times \sqrt{F}$  (GHz) dB

Center Contact Resistance

$\leq 1$  m $\Omega$

Outer Contact Resistance

$\leq 0.25$  m $\Omega$

Power handling

1 Watt

### Material And Plating

Piece Parts	Material	Plating
Centre contact	Phosphor Bronze	Gold plating, 3 $\mu$ inch (Non-magnetic nickel-phosphorus underplating, 80 $\mu$ inch)
Body	Brass	Nickel
Insulator	PTFE	

### Mechanical Data

Coupling mechanisms

Screw-lock

Mating Cycles

$\geq 500$

Coupling Test Torque

max. 1.7 Nm

Recommended Torque

0.7 Nm to 1.1 Nm

### Environmental Data

Temperature Range

-55°C to +125°C

RoHS

compliant

### Packing

Single or 100