

2 Watt RF Load Up to 4 GHz With SMA Plug (Male)

T-A15-4G2WA / 111

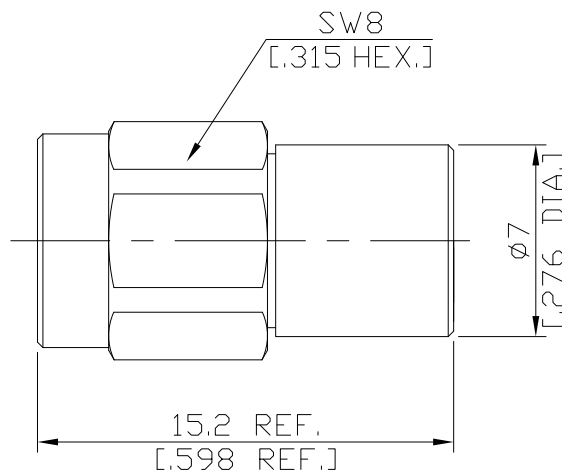

All dimensions are in mm [inch]

Tolerances according to DIN ISO 2768-mH

Interface

According to

IEC 60169-15; CECC 22110; MIL-PRF-39012; MIL-STD-348B/310; EN 122110

Electrical Data

Impedance

50 Ω

Frequency

DC to 4 GHz

VSWR (Return Loss)

≤ 1.15 (≥ 23.13 dB)

Average power (at 25 °C)

2 Watt

Material And Plating

| Piece Parts | Material | Plating |
|----------------|-----------------|---|
| Centre Contact | Brass | Gold plating (Non-magnetic nickel-phosphorus underplating) |
| Body | Brass | Gold plating (Non-magnetic nickel-phosphorus underplating) |
| Insulator | PTFE | |
| Gasket | Silicone Rubber | |
| Coupling Nut | Brass | Gold plating (Non-magnetic nickel-phosphorus underplating) |

Mechanical Data

| | |
|----------------------------|--------------|
| Coupling mechanisms | Screw-lock |
| Mating Cycles | ≥ 500 |
| Coupling Nut Retention | ≥ 270 N |
| Center Contact Captivation | ≥ 20 N |
| Coupling Test Torque | 1.70 Nm max. |
| Recommended Torque | 0.57 Nm |

Environmental Data

| | |
|-------------------|-------------------|
| Temperature Range | -55 °C to +125 °C |
| RoHS | compliant |

Packing

Single or 100