

2 Watt RF Load Up to 18 GHz With SMA Plug (Male)

T-A15-18G2WA / 1XQ

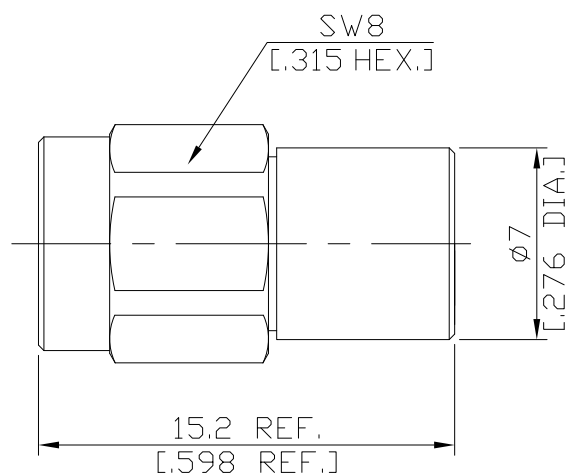

All dimensions are in mm [inch]

Tolerances according to DIN ISO 2768-mH

Interface

According to

IEC 60169-15; CECC 22110; MIL-PRF-39012; MIL-STD-348B/310; EN 122110

Electrical Data

Impedance

50 Ω

Frequency

DC to 18 GHz

VSWR (Return Loss)

≤ 1.2 (≥ 20.83 dB)

Average power (at 25 °C)

2 Watt

Material And Plating

Piece Parts	Material	Plating
Centre Contact	Brass	Gold plating (Non-magnetic nickel-phosphorus underplating)
Body	Stainless Steel	Passivated
Insulator	PTFE	
Gasket	Silicone Rubber	
Coupling Nut	Stainless Steel	Gold plating (Non-magnetic nickel-phosphorus underplating)

Mechanical Data

Coupling mechanisms

Screw-lock

Mating Cycles

≥ 500

Coupling Nut Retention

≥ 270 N

Center Contact Captivation

≥ 20 N

Coupling Test Torque

1.70 Nm max.

Recommended Torque

0.8 Nm to 1.1 Nm

Environmental Data

Temperature Range

-55 °C to +125 °C

RoHS

compliant

Packing

Single or 100