

2.4mm plug (male)/2.4mm plug (male) L-adaptor  
DC-50GHz VSWR 1.33

**ASL-Q1Q15A / 9XX-9XX**

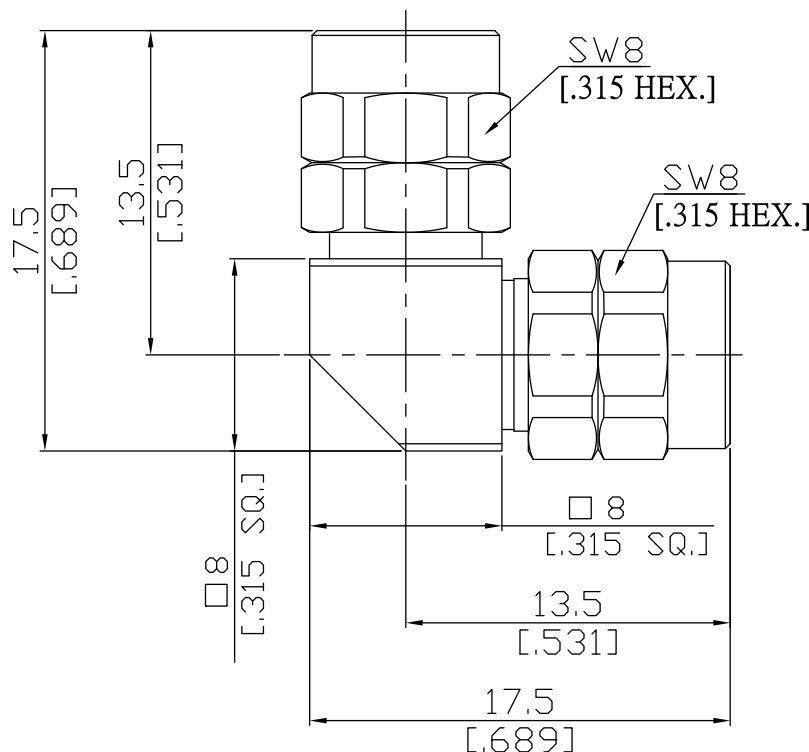

All dimensions are in mm [inch]

Tolerances according to DIN ISO 2768-mH

**Interface**

according to

IEC 61169-40; MIL-STD-348B/324

**Electrical Data**

Impedance

50 Ω

Frequency

DC to 50 GHz

VSWR (Return Loss)

≥ 1.33 (≥ 17 dB)

Insertion Loss

≤ 0.05 × √F (GHz) dB

Insulation resistance

≥ 5 GΩ

Test voltage

500 V rms

Working voltage

150 V rms

RF-leakage

≥ 100 dB up to 1 GHz

**Material And Plating**

| Piece Parts (2.4mm) | Material         | Plating  |
|---------------------|------------------|--|
| Centre contact      | Beryllium Copper | Gold plating, 3 pinch<br>(Non-magnetic nickel-phosphorus underplating, 80 pinch) |
| Body                | Stainless Steel  | Passivated   |
| Insulator           | PS               |  |
| Coupling nut        | Stainless Steel  | Passivated   |
| Piece Parts (2.4mm) | Material         | Plating  |
| Centre contact      | Beryllium Copper | Gold plating, 3 pinch<br>(Non-magnetic nickel-phosphorus underplating, 80 pinch) |
| Body                | Stainless Steel  | Passivated   |
| Insulator           | PS               |  |
| Coupling nut        | Stainless Steel  | Passivated   |

2.4mm plug (male)/2.4mm plug (male) L-adaptor  
DC-50GHz VSWR 1.33

**ASL-Q1Q15A / 9XX-9XX**

**Mechanical Data**

|                                   |                    |
|-----------------------------------|--------------------|
| Coupling mechanisms               | Screw-lock         |
| Mating cycles                     | ≥ 500              |
| Center contact captivation: axial | ≥ 20 N             |
| Coupling test torque              | 1.65 Nm            |
| Recommended torque                | 0.80 Nm to 1.10 Nm |

**Environmental Data**

|                     |                               |
|---------------------|-------------------------------|
| Temperature Range   | -40°C to +85°C                |
| Thermal shock       | IEC 61169-1, Subclause 9.4.4  |
| Corrosion           | IEC 61169-1, Subclause 9.4.6  |
| Vibration           | IEC 61169-1, Subclause 9.3.3  |
| Shock               | IEC 61169-1, Subclause 9.3.14 |
| Moisture resistance | IEC 61169-1, Subclause 9.4.3  |
| RoHS                | compliant                     |

**Packing**

Single or 100