

SMB jack (female) / SMB plug (male) /SMB jack (female)
T-Adaptor 1 plug , 2 jacks DC-4 GHz

ADT-S2S1S25A / 11-911-11

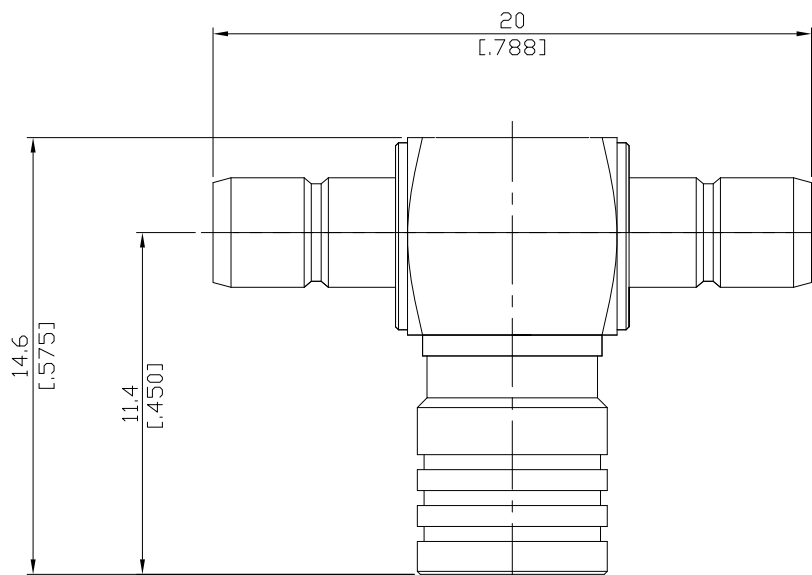

All dimensions are in mm [inch]

Tolerances according to DIN ISO 2768-mH

Interface

according to

MIL-C-39012; MIL-STD-348B/311

Electrical Data

Impedance	50 Ω
Frequency	DC to 4 GHz
Insulation resistance	$\geq 1 \text{ m}\Omega$
Center contact resistance	$\leq 5 \text{ m}\Omega$
Outer contact resistance	$\leq 2.5 \text{ m}\Omega$
Test voltage	750 V rms, 50 Hz, at sea level
Working voltage	$\leq 250 \text{ V rms}$, 50 Hz, at sea level
RF-leakage	$\leq 55 \text{ dB}$ up to 1 GHz

Material And Plating

Piece Parts (SMB)	Material	Plating
Centre contact	Beryllium Copper	Gold plating, 3 μ inch (Non-magnetic nickel-phosphorus underplating, 80 μ inch)
Body	Brass	Gold plating, 3 μ inch (Non-magnetic nickel-phosphorus underplating, 80 μ inch)
Insulator	PTFE	
Coupling nut	Brass	Gold plating, 3 μ inch (Non-magnetic nickel-phosphorus underplating, 80 μ inch)
Piece Parts (SMB)	Material	Plating
Centre contact	Brass	Gold plating, 3 μ inch (Non-magnetic nickel-phosphorus underplating, 80 μ inch)
Body	Brass	Gold plating, 3 μ inch (Non-magnetic nickel-phosphorus underplating, 80 μ inch)
Insulator	PTFE	

SMB jack (female) / SMB plug (male) /SMB jack (female)
T-Adaptor 1 plug , 2 jacks DC-4 GHz

ADT-S2S1S25A / 11-911-11

Mechanical Data

Coupling mechanisms	Snap-on
Mating cycles	≥ 500
Center contact captivation: axial	≥ 10 N
Engagement force	≤ 63 N
Disengagement force	8 N min. to 63 N max.

Environmental Data

Temperature Range	-55°C to +155°C
Thermal shock	MIL-STD-202, Meth. 107, Cond. B
Vibration	MIL-STD-202, Meth. 204, Cond. B
Corrosion	MIL-STD-202, Meth. 101, Cond. B
Moisture resistance	MIL-STD-202, Meth. 106
RoHS	compliant

Packing

Single or 100