

1.85mm plug (male) / 1.85mm jack (female) Straight Adaptor DC-67 GHz, VSWR ≤ 1.25

AD-V1V25A / 9XX-9X

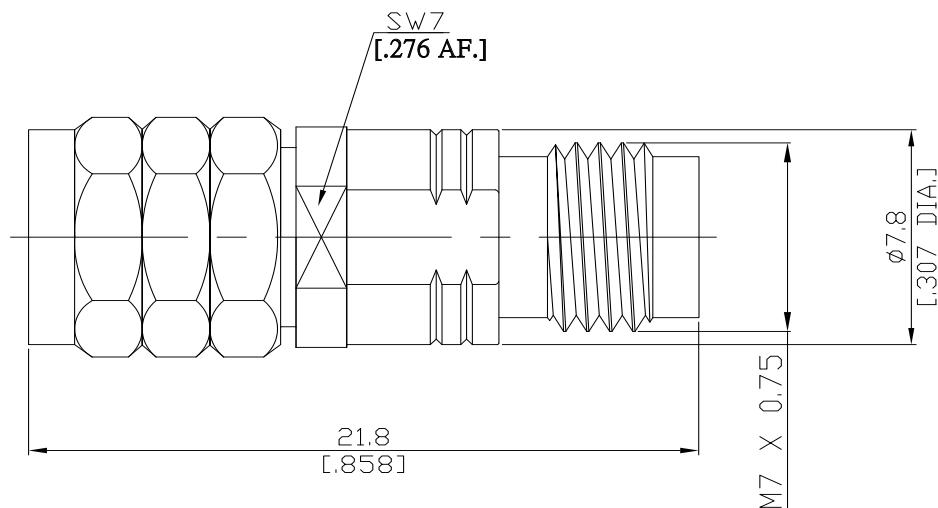

All dimensions are in mm [inch]

Tolerances according to DIN ISO 2768-mH

Interface

according to

IEC 61169-32

Mechanically compatible with

2.4mm

Electrical Data

Impedance

50 Ω

Frequency

DC to 67 GHz

VSWR (Return Loss)

≤ 1.25 (≥ 19.08 dB)

Insertion Loss

≤ 0.05 × √F (GHz) dB

Center contact resistance

≤ 4.0 mΩ

Outer contact resistance

≤ 2.5 mΩ

Test voltage

500 V rms

Working voltage

150 V rms

RFleakage

≥ 100 dB up to 1 GHz

Material And Plating

Piece Parts (1.85mm)	Material	Plating
Centre contact	Beryllium Copper	Gold plating, 3 μinch (Non-magnetic nickel-phosphorus underplating, 80 μinch)
Body	Stainless Steel	Passivated
Insulator	PS	
Coupling nut	Stainless Steel	Passivated
Piece Parts (1.85mm)	Material	Plating
Centre contact	Beryllium Copper	Gold plating, 3 μinch (Non-magnetic nickel-phosphorus underplating, 80 μinch)
Body	Stainless Steel	Passivated
Insulator	PS	

1.85mm plug (male) / 1.85mm jack (female) Straight Adaptor DC-67 GHz, VSWR ≤ 1.25

AD-V1V25A / 9XX-9X

Mechanical Data

Coupling mechanisms	Screw-lock
Mating cycles	≥ 500
Center contact captivation	≥ 20 N
Coupling test torque	1.65 Nm
Recommended torque	0.80 Nm to 1.10 Nm

Environmental Data

Temperature Range	-60°C to +100°C
Thermal shock	IEC 611691, Subclause 9.4.4
Corrosion	IEC 611691, Subclause 9.4.6
Vibration	IEC 611691, Subclause 9.3.3
Shock	IEC 611691, Subclause 9.3.14
Moisture resistance	IEC 611691, Subclause 9.4.3
RoHS	compliant

Packing

Single or 100