

Adaptor plug/jack
UHF plug (male) / Type C jack (female)

AD-U1C25A/H44-H4

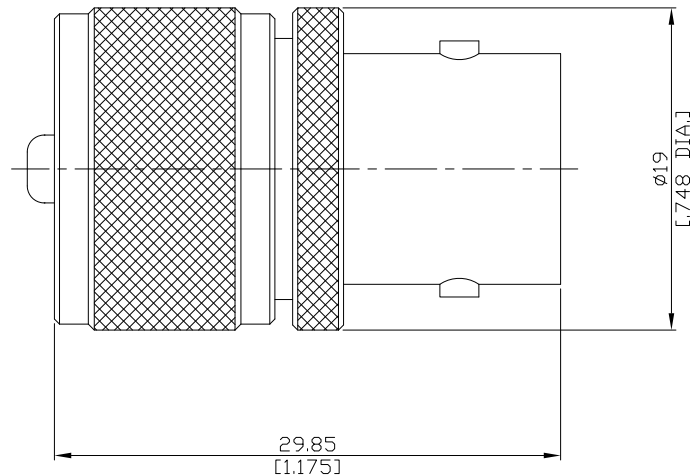

All dimensions are in mm [inch]

Tolerances according to DIN ISO 2768-mH

Interface

UHF Side According to IEC 60169-12
Type C Side According to MIL-STD-348A/401

Electrical Data

Impedance 50 Ω
Frequency DC to 300 MHz
VSWR (Return Loss) ≤ 1.15 (≥ 23.13 dB)
Insertion Loss $\leq 0.04 \times \sqrt{F}$ (GHz) dB

Mechanical Data

Coupling mechanisms UHF (Screw-lock) ; Type C (Bayonet-lock)

Environmental Data

Temperature range -65°C to +165°C
RoHS compliant

Material And Plating

Piece Parts (UHF)	Material	Plating
Centre contact	Phosphor Bronze	Gold plating(Nickel underplated)
Body	Brass	Copper-Tin-Zinc Alloy
Insulator	PTFE	
Coupling nut	Brass	Copper-Tin-Zinc Alloy
Piece Parts (Type C)	Material	Plating
Centre contact	Phosphor Bronze	Gold plating(Nickel underplated)
Body	Brass	Copper-Tin-Zinc Alloy
Insulator	PTFE	

Packing

Single or 100