

SC plug (male) / 7/16 jack (female) Straight Adapter DC-7.5 GHz

AD-SC1D25A / H44-H4

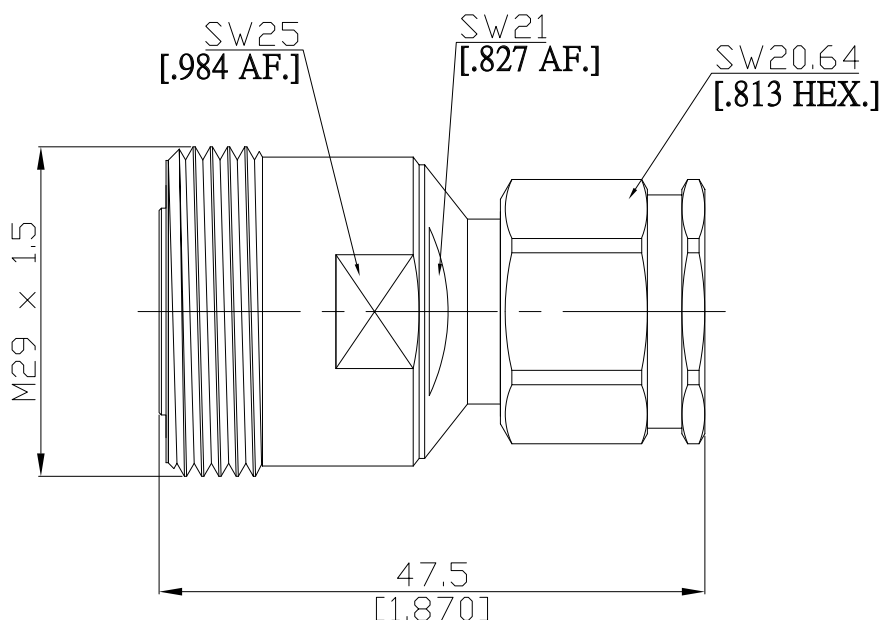

All dimensions are in mm [inch]

Tolerances according to DIN ISO 2768-mH

Interface

7/16 according to

IEC 61169-4

SC according to

MIL-C-39012; MIL-STD-348B/309

Electrical Data

Impedance

50 Ω

Frequency

DC to 7.5 GHz

Mechanical Data

Coupling mechanisms

7/16 side

SC side

Mating cycles

Screw-lock

Screw-lock

≥ 500

≥ 500

Environmental Data

Temperature range

-65°C to +165°C

RoHS

compliant

Material And Plating

Piece Parts (SC)	Material	Plating
Centre contact	Phosphor Bronze	Gold plating, 3 pinch (Non-magnetic nickel-phosphorus underplating, 80 pinch)
Body	Brass	Copper-Tin-Zinc Alloy
Insulator	PTFE	
Coupling nut	Brass	Copper-Tin-Zinc Alloy
Piece Parts (7/16)	Material	Plating
Centre contact	Phosphor Bronze	Gold plating, 3 pinch (Non-magnetic nickel-phosphorus underplating, 80 pinch)
Body	Brass	Copper-Tin-Zinc Alloy
Insulator	PTFE	

Packing

Single or 100