

RCA plug (male) / BNC jack (female) Straight adaptor DC- 250 MHz

## AD-RCA1B25A / 133-H3

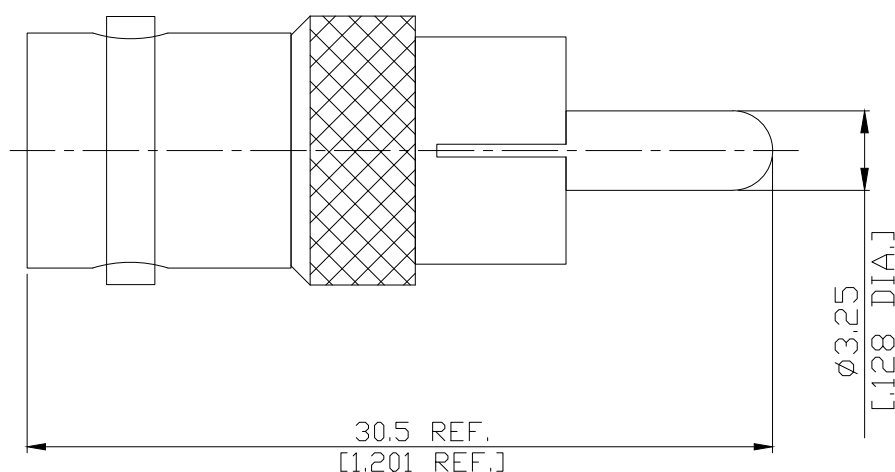

All dimensions are in mm [inch]

Tolerances according to DIN ISO 2768-mH

### Interface

BNC side according to

IEC 60169-8; MIL-STD-348B/301

RCA side according to

N/A

### Electrical Data

Impedance

50 Ω

Frequency

DC to 250 MHz

VSWR (Return Loss)

N/A

Insertion Loss

N/A

Center contact resistance

≤ 1.5 mΩ, BNC side

N/A, RCA side

Outer contact resistance

≤ 1 mΩ, BNC side

N/A, RCA side

Dielectric Withstanding Voltage

≤1500 V

Operating voltage

500 V rms

### Material And Plating

Piece Parts (BNC)	Material	Plating
Centre contact	Brass	Gold plating, 3 μinch (Non-magnetic nickel-phosphorus underplating, 80 μinch)
Body	Brass	Nickel
Insulator	PTFE	
Gasket	Silicone Rubber	
Piece Parts (SMA)	Material	Plating
Centre contact	Beryllium Copper	Gold plating, 3 μinch (Non-magnetic nickel-phosphorus underplating, 80 μinch)
Body	Brass	Nickel
Insulator	PTFE	

RCA plug (male) / BNC jack (female) Straight adaptor DC- 250 MHz

## AD-RCA1B25A / 133-H3

### Mechanical Data

Coupling mechanisms	BNC side	RCA side
Mating cycles	Bayonet-lock	Push-on
Center contact captivation: axial	min. 500	min. 500
Coupling test torque	≥ 28 N	N/A
Recommended torque	N/A	N/A
	N/A	N/A

### Environmental Data

Temperature Range	-40°C to +60°C
Thermal shock	MIL-STD-202, Meth. 107, Cond. B
Corrosion	MIL-STD-202, Meth. 101, Cond. B
Vibration	MIL-STD-202, Meth. 204, Cond. D
Shock	MIL-STD-202, Meth. 213, Cond. I
Moisture resistance	MIL-STD-202, Meth. 106
RoHS	compliant

### Packing

Single or 100