

2.4mm plug (male) / 1.85mm jack (Female)
Adaptors Straight DC-50 GHz VSWR1.20

AD-Q1V25A / 9XX-9X

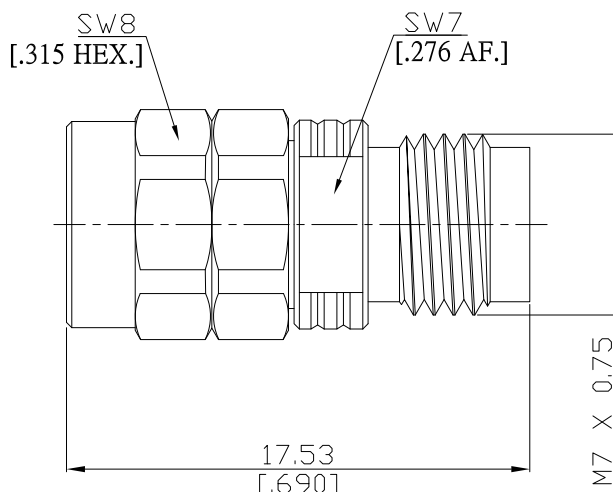

All dimensions are in mm [inch]

Tolerances according to DIN ISO 2768-mH

Interface

2.4mm according to

IEC 61169-40

1.85mm according to

IEC 61169-32

Mechanically compatible with

1.85mm, 2.4mm

Electrical Data

Impedance

50 Ω

Frequency

DC to 50 GHz

VSWR (Return Loss)

≤ 1.20 (≥ 20.8 dB)

Insertion Loss

≤ 0.05 x √F (GHz) dB

Mechanical Data

Coupling mechanisms

2.4mm Side

1.85mm Side

Mating cycles

Screw-lock

Screw-lock

Center Contact Captivation

min. 500

min. 500

Coupling test torque

≥ 20 N

≥ 20 N

Recommended torque

1.65 Nm

1.65 Nm

0.80 Nm to 1.10 Nm

0.80 Nm to 1.10 Nm

Environmental Data

Temperature Range

-60°C to +100°C

RoHS

compliant

Material And Plating

Piece Parts (2.4mm)

Centre contact

Material

Beryllium Copper

Plating

Gold plating, 3 μinch
(Non-magnetic nickel-phosphorus underplating, 80 μinch)

Body

Stainless Steel

Passivated

Insulator

PS

Coupling nut

Stainless Steel

Passivated

Piece Parts (1.85mm)

Centre contact

Material

Beryllium Copper

Plating

Gold plating, 3 μinch
(Non-magnetic nickel-phosphorus underplating, 80 μinch)

Body

Stainless Steel

Passivated

Insulator

PS

Packing

Single or 100