

2.4mm plug (male) / SMPM jack (female)
Straight Adapter DC-40GHz VSWR1.25

AD-Q1PM25A / 9XX-99

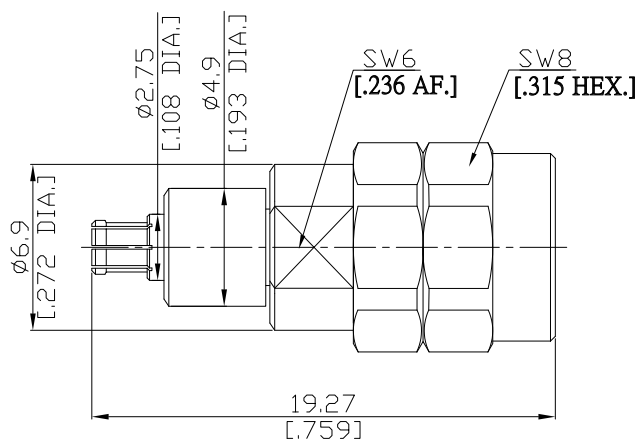

All dimensions are in mm [inch]

Tolerances according to DIN ISO 2768-mH

Interface

2.4mm according to
SMPM according to

IEC 61169-40; MIL-STD-348B/324
MIL-STD-348B/328

Electrical Data

Impedance

50 Ω

Frequency

DC to 40 GHz

VSWR (Return Loss)

≤ 1.25 (≥ 19.1 dB)

Insertion Loss

≤ 0.05 x √F [GHz] dB

Mechanical Data

Coupling mechanisms

2.4mm Side

SMPM Side

Mating Cycles

Screw-lock

Snap-lock

Coupling Nut Retention

≥ 500

Full detent: ≥ 100; Smooth bore: ≥ 500

Center Contact Captivation

≥ 270 N

≥ 270 N

Coupling Test Torque

≥ 20 N

≥ 20 N

Recommended Torque

1.65 Nm max.

1.65 Nm

0.9 Nm

0.80 Nm to 1.10 Nm

Environmental Data

Temperature Range

-55°C to +125°C

RoHS

compliant

Material And Plating

Piece Parts (2.4mm)	Material	Plating
Centre contact	Beryllium Copper	Gold plating, 3 μinch (Non-magnetic nickel-phosphorus underplating, 80 μinch)
Body	Stainless Steel	Passivated
Insulator	PS	
Gasket	Silicone Rubber	
Coupling nut	Stainless Steel	Passivated
Piece Parts (SMPM)	Material	Plating
Centre contact	Beryllium Copper	Gold plating, 3 μinch (Non-magnetic nickel-phosphorus underplating, 80 μinch)
Body	Beryllium Copper	Gold plating, 3 μinch (Non-magnetic nickel-phosphorus underplating, 80 μinch)
Insulator	PS	

Packing

Single or 100