

**SMPM Plug (Male) to SMPM Plug (Male) Full Detent Bulkhead Mount Adapter
DC-65GHz**

AD-PMF1PMF15B-BH / 9X-9X

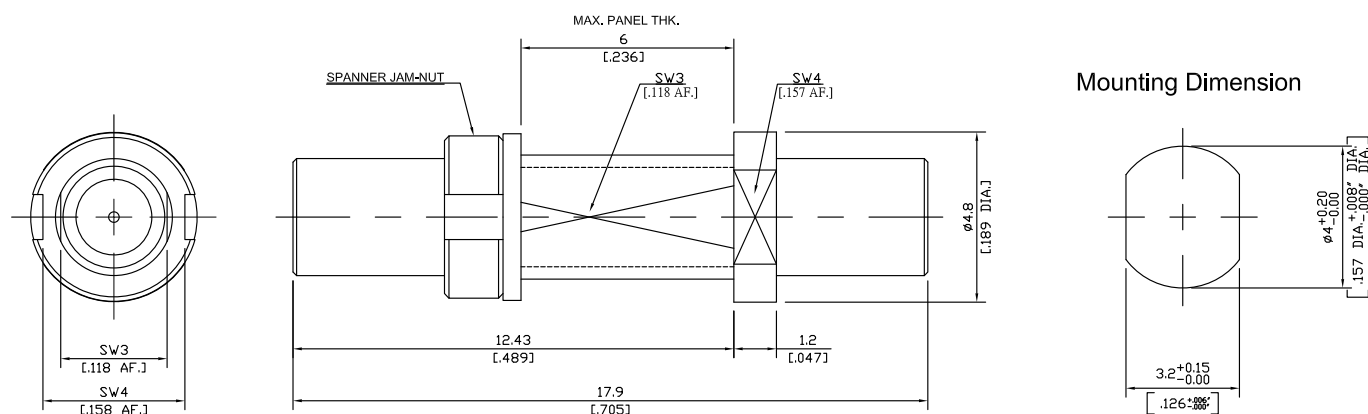

All dimensions are in mm [inch]

Tolerances according to DIN ISO 2768-mH

Interface

Mechanically compatible with

According to

GPPO, Mini SMP

MIL-STD-348B/328

Electrical Data

Impedance

50 Ω

Frequency

DC to 65 GHz

VSWR (Return Loss)

≤ 1.4 (≥ 15.56 dB) DC-50 GHz

Insertion Loss

≤ 0.07 x √F (GHz) dB

Material And Plating

Piece Parts (SMPM)	Material	Plating
Centre Contact	Beryllium Copper	Gold plating, 3 μinch (Non-magnetic nickel-phosphorus underplating, 80 μinch)
Body	Stainless Steel	Passivated
Insulator	PEI	
Fastening Nut	Stainless Steel	Passivated
Washer	Stainless Steel	Passivated
Piece Parts (SMPM)	Material	Plating
Centre Contact	Beryllium Copper	Gold plating, 3 μinch (Non-magnetic nickel-phosphorus underplating, 80 μinch)
Body	Stainless Steel	Passivated
Insulator	PEI	

SMPM Plug (Male) to SMPM Plug (Male) Full Detent Bulkhead Mount Adapter
DC-65GHz

AD-PMF1PMF15B-BH / 9X-9X

Mechanical Data

Coupling mechanisms	Snap-on
Mating Cycles	≥ 100
Engagement Force	
Full Detent	19 N typical
Disengagement Force	
Full Detent	29 Nm max.

Environmental Data

Temperature Range	-40°C to +85°C
RoHS	compliant

Packing

Single or 100