

SMPM plug (male - full detent) / SMPM plug (male - full detent)
Thread-in Adaptor DC-40 GHz, VSWR ≤ 1.29

AD-PMF1PMF15A-BH / 9X-9X

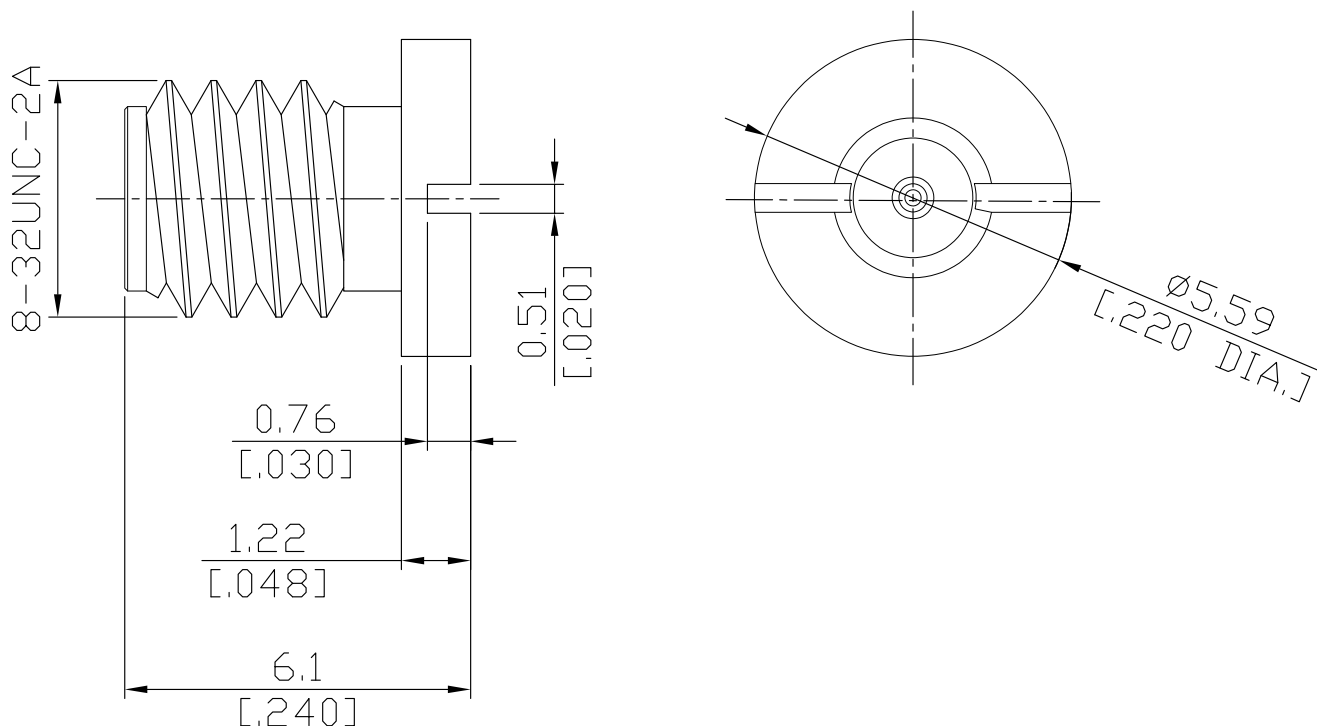

All dimensions are in mm [inch]

Tolerances according to DIN ISO 2768-mH

Interface

according to

MIL-STD-348B/328

Electrical Data

Impedance

50 Ω

Frequency

DC to 40 GHz

VSWR (Return Loss)

≤ 1.29 (≥ 18 dB)

Material And Plating

Piece Parts (SMPM - Full Detent)	Material	Plating
Centre contact	Beryllium Copper	Gold plating, 3 pinch (Non-magnetic nickel-phosphorus underplating, 80 pinch)
Body	Stainless Steel	Passivated
Insulator	PEI	
Piece Parts (SMPM - Full Detent)	Material	Plating
Centre contact	Beryllium Copper	Gold plating, 3 pinch (Non-magnetic nickel-phosphorus underplating, 80 pinch)
Body	Stainless Steel	Passivated
Insulator	PEI	

SMPM plug (male - full detent) / SMPM plug (male - full detent)
Thread-in Adaptor DC-40 GHz, VSWR ≤ 1.29

AD-PMF1PMF15A-BH / 9X-9X

Mechanical Data

Coupling mechanisms	Snap-On
Mating cycles	≥ 100
Engagement force	
- Full detent	68 N
Disengagement force	
- Full detent	22 N
Gauge	0.00 mm to 0.05 mm

Environmental Data

Temperature Range	-65 °C to +155 °C
Operating temperature range	+ 20 °C to +26 °C
Rated temperature range of use	0 °C to +50 °C
Storage temperature range	- 40 °C to +85 °C
RoHS	compliant

Packing

Single or 100