

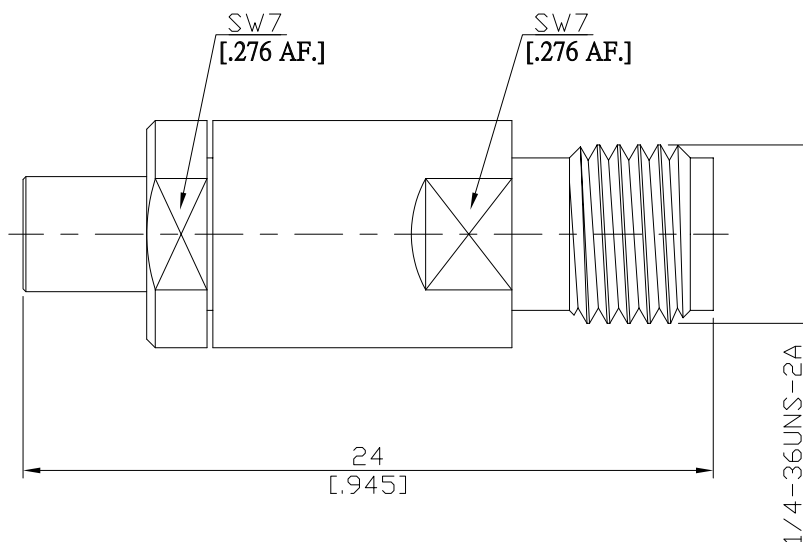

Adaptor plug/jack  
SMPM plug (male - full detent) / SMA jack (female)

AD-PMFD1A25A/9X-9X



All dimensions are in mm [inch]

Tolerances according to DIN ISO 2768-mH

#### Interface

SMPM Side According to  
SMA side according to

MIL-STD-348B/328-2  
IEC 60169-15; MIL-STD-348A/310

#### Electrical Data

Impedance

50  $\Omega$

Frequency

DC to 18 GHz

VSWR (Return Loss)

$\leq 1.35$  ( $\geq 16.54$  dB)

Insertion Loss

$\leq 0.05 \times \sqrt{F}$  (GHz) dB

#### Mechanical Data

Coupling mechanisms

SMPM (Snap-lock); SMA (Screw-lock)

Weight

N/A

#### Environmental Data

Temperature range

-55°C to +165°C

RoHS

compliant

#### Material And Plating

Piece Parts (SMPM)	Material	Plating
Centre contact	Beryllium Copper	Gold plating(Nickel underplated)
Body	Stainless Steel	Passivated
Insulator	PEI	
Piece Parts (SMA)	Material	Plating
Centre contact	Beryllium Copper	Gold plating(Nickel underplated)
Body	Stainless Steel	Passivated
Insulator	PTFE	

#### Packing

Single or 100