

N Snap-On plug (male) / N plug (male)
Straight adaptor DC-11 GHz VSWR ≤ 1.20

AD-NQ1N15A / H44-H44

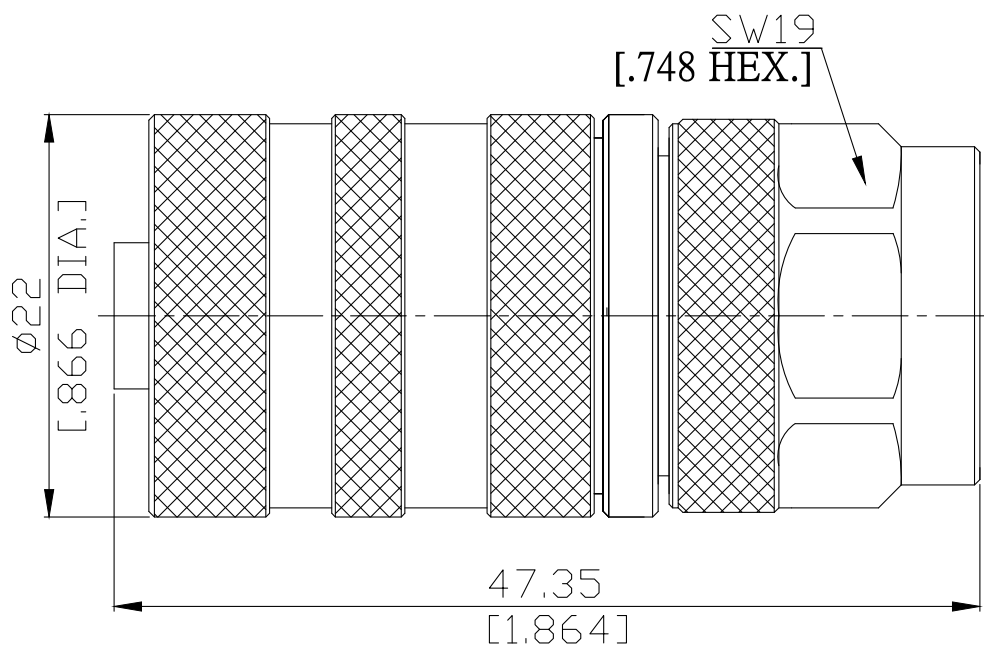

All dimensions are in mm [inch]

Tolerances according to DIN ISO 2768-mH

Interface

according to

IEC 61169-8; MIL-STD-348B/301

Electrical Data

Impedance

50 Ω

Frequency

DC to 11 GHz

VSWR (Return Loss)

≤ 1.20 (≥ 20.8 dB)

Insertion loss

≤ 0.04 × √F (GHz) dB

Insulation resistance

≥ 5 GΩ

Center contact resistance

≤ 1 mΩ

Outer contact resistance

≤ 0.25 mΩ

Working voltage (at sea level)

500 V rms

Power handling (at 20 °C, sea level, VSWR 1.0)

1000 W @ 1 GHz

700 W @ 2 GHz

RF-leakage

≥ 128 dB @ DC to 1 GHz

Material And Plating

Piece Parts (N Snap-On)	Material	Plating
Centre contact	Phosphor Bronze	Gold plating, 3 μinch (Non-magnetic nickel-phosphorus underplating, 80 μinch)
Body	Brass	Copper-Tin-Zinc Alloy
Insulator	PTFE	
Gasket	Silicone Rubber	
Coupling nut	Brass	Copper-Tin-Zinc Alloy
Piece Parts (N)	Material	Plating
Centre contact	Phosphor Bronze	Gold plating, 3 μinch (Non-magnetic nickel-phosphorus underplating, 80 μinch)
Body	Brass	Copper-Tin-Zinc Alloy
Insulator	PTFE	
Coupling nut	Brass	Copper-Tin-Zinc Alloy

N Snap-On plug (male) / N plug (male)
Straight adaptor DC-11 GHz VSWR ≤ 1.20

AD-NQ1N15A / H44-H44

Mechanical Data

Coupling mechanisms	N side	N side
Mating cycles	Snap-On	Screw-lock
Center contact captivation: axial	≥ 200	≥ 500
Coupling test torque	≥ 28 N	≥ 28 N
Recommended torque	N/A	≤ 1.7 Nm
Engagement force	N/A	0.7 Nm to 1.1 Nm
Disengagement force	30 N typical	N/A
	30 N typical	N/A

Environmental Data

Temperature range	-65°C to +165°C
RoHS	compliant

Packing

Single or 100