

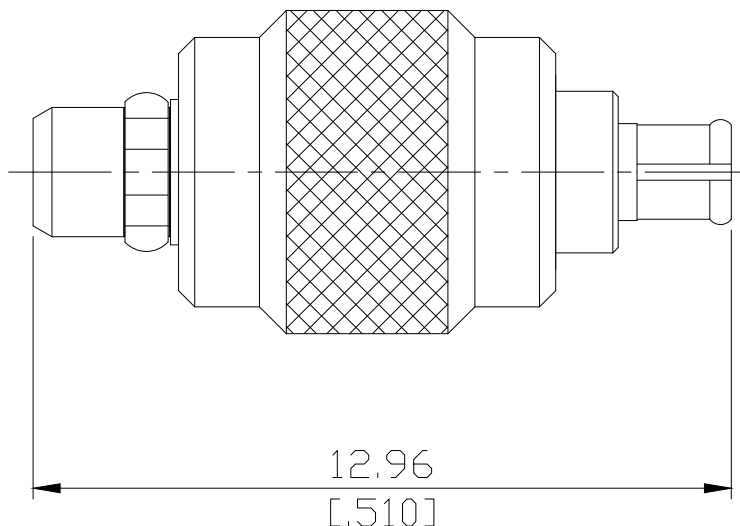

MMCX plug (male) / SSMCX plug (male)
Straight adaptor DC- 6 GHz VSWR ≤ 1.60

AD-MX1SX15A / H3-H3



All dimensions are in mm [inch]

Tolerances according to DIN ISO 2768-mH

Interface

MMCX according to
SSMCX according to

IEC 60169-36
N/A

Electrical Data

Impedance	50 Ω	
Frequency	DC to 6 GHz	
VSWR (Return Loss)	≤ 1.60 (≥ 12.7 dB)	
Insertion loss	≤ 0.1 x √F (GHz) dB	
Insulation resistance	≥ 1 GΩ	
Center contact resistance	≤ 5 mΩ, MMCX side	≤ 6.0 mΩ, SSMCX side;
Outer contact resistance	≤ 2.5 mΩ, MMCX side	≤ 3 mΩ, SSMCX side;
Test voltage	500 V rms	
Working voltage	170 V rms	

Material And Plating

Piece Parts (MMCX)	Material	Plating
Centre contact	Phosphor Bronze	Gold plating, 3 pinch (Non-magnetic nickel-phosphorus underplating, 80 μinc)
Body	Brass	Nickel
Insulator	PTFE	
Piece Parts (SSMCX)	Material	Plating
Centre contact	Phosphor Bronze	Gold plating, 3 pinch (Non-magnetic nickel-phosphorus underplating, 80 μinc)
Body	Brass	Nickel
Insulator	PTFE	

MMCX plug (male) / SSMCX plug (male)
Straight adaptor DC- 6 GHz VSWR ≤ 1.60

AD-MX1SX15A / H3-H3

Mechanical Data

	MMCX side	SSMCX side
Coupling mechanisms	Snap-lock	Snap-lock
Mating cycles	≥ 500	≥ 500
Center contact captivation: axial	≥ 27 N	≥ 27 N
Engagement force	≤ 25 N	≤ 3 lbs; 4.06 N
Disengagement force	8N min to 20 N max.	≤ 1 lbs; 1.36 N

Environmental Data

Temperature range	-55°C to +155°C
RoHS	compliant

Packing

Single or 100