

SMC Plug (Male) to FME Plug (Male)
Adapter DC-2 GHz VSWR1.20

AD-MC1E15A / H44-H4

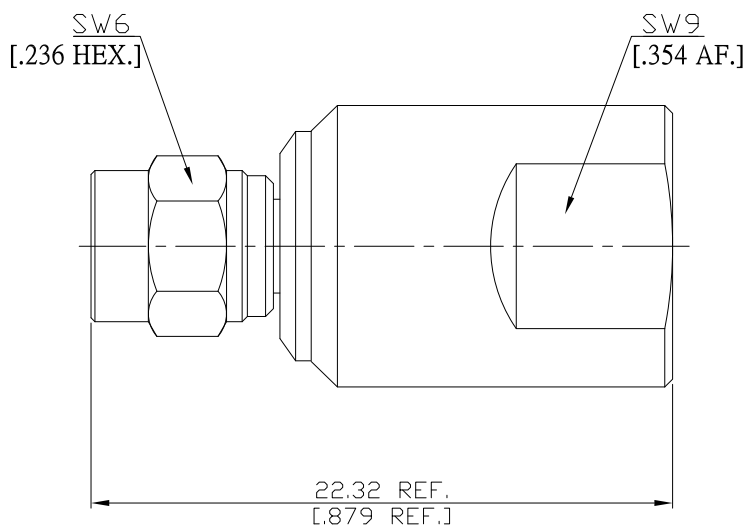

All dimensions are in mm [inch]

Tolerances according to DIN ISO 2768-mH

Interface

SMC side according to

IEC 60169-9; MIL-STD-348B/312

FME side according to

N/A

Electrical Data

Impedance

50 Ω

Frequency

DC to 2 GHz

VSWR (Return Loss)

≤ 1.20 (≥ 20.83 dB)

Insertion Loss

≤ 0.01 × √F (GHz) dB

Center Contact Resistance

≤ 5 mΩ, SMC side

≤ 10 mΩ, FME side

Outer Contact Resistance

≤ 2.5 mΩ, SMC side

≤ 5 mΩ, FME side

Material And Plating

Piece Parts (SMC)	Material	Plating
Centre contact	Beryllium Copper	Gold plating, 3 μinch (Non-magnetic nickel-phosphorus underplating, 80 μinch)
Body	Brass	Copper-Tin-Zinc Alloy
Insulator	PTFE	
Coupling nut	Brass	Copper-Tin-Zinc Alloy
Piece Parts (FME)	Material	Plating
Centre contact	Beryllium Copper	Gold plating, 3 μinch (Non-magnetic nickel-phosphorus underplating, 80 μinch)
Body	Brass	Copper-Tin-Zinc Alloy
Insulator	PTFE	

SMC Plug (Male) to FME Plug (Male)
Adapter DC-2 GHz VSWR1.20

AD-MC1E15A / H44-H4

Mechanical Data

	SMC Side	FME Side
Coupling mechanisms	Screw-lock	Screw-lock
Mating Cycles	min. 500	≥ 300
Coupling nut retention	≥ 150 N	N/A
Coupling test torque	max. 0.71 Nm	≤ 2 Nm
Recommended torque	0.25 Nm to 0.35 Nm	N/A
Center contact captivation: axial	≥ 10 N	N/A

Environmental Data

Temperature Range	-65°C to +165°C
RoHS	compliant

Packing

Single or 100