

MCX plug (male) / BNC jack (female)
Straight Adaptor DC-4 GHz VSWR 1.15

AD-M1B25A / 99-93

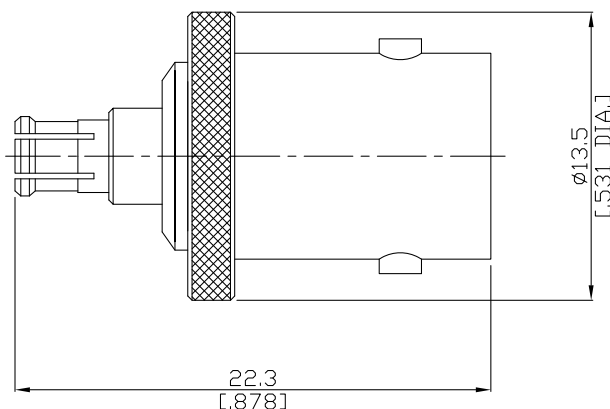

All dimensions are in mm [inch]

Tolerances according to DIN ISO 2768-mH

Interface

MCX according to

IEC 60169-36

BNC according to

IEC 60169-8; MIL-STD-348B/301

Electrical Data

Impedance

50 Ω

Frequency

DC to 4 GHz

VSWR (Return Loss)

≤ 1.15 (≥ 23.1 dB)

Insertion loss

$\leq 0.05 \times \sqrt{F}$ (GHz) dB

Mechanical Data

Coupling mechanisms

MCX side

BNC side

Mating cycles

Snap-lock

Bayonet-lock

Center contact captivation: axial

≥ 500

≥ 500

Disengagement force

≥ 28 N

≥ 27 N

8 N min. to 20 N max.

N/A

Environmental Data

Temperature Range

-65°C to +165°C

RoHS

compliant

Material And Plating

Piece Parts (MCX)	Material	Plating
Centre contact	Beryllium Copper	Gold plating, 3 μ inch (Non-magnetic nickel-phosphorus underplating, 80 μ inch)
Body	Beryllium Copper	Gold plating, 3 μ inch (Non-magnetic nickel-phosphorus underplating, 80 μ inch)
Insulator	PTFE	
Piece Parts (BNC)	Material	Plating
Centre contact	Beryllium Copper	Gold plating, 3 μ inch (Non-magnetic nickel-phosphorus underplating, 80 μ inch)
Body	Brass	Nickel
Insulator	PTFE	

Packing

Single or 100