

BMMA Jack(female) to SMA Jack(female) Straight Adapter DC-18GHz, VSWR ≤ 1.2

AD-BM2A25A-PT / 9X-9X

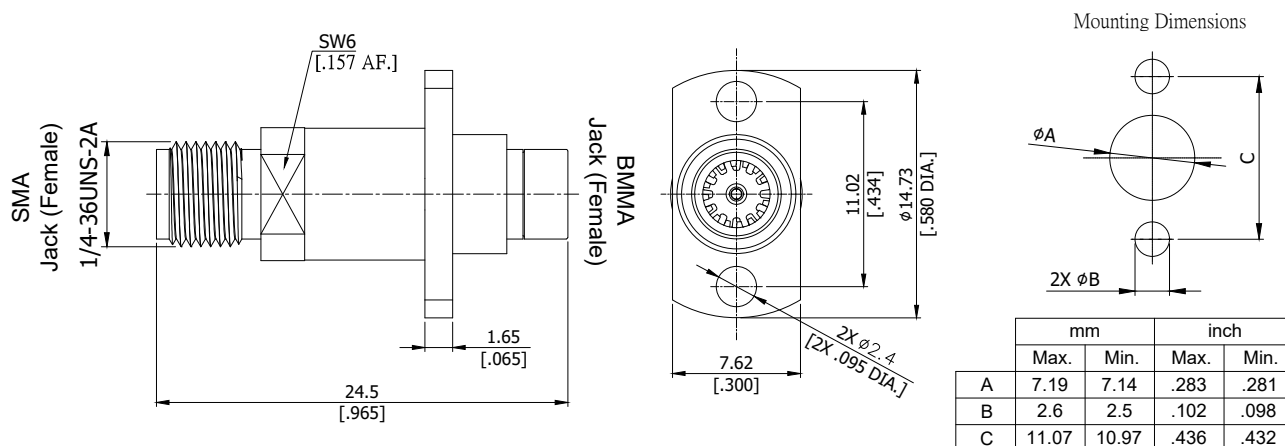

All dimensions are in mm [inch]

Tolerances according to DIN ISO 2768-mH

Interface

BMMA according to

MIL-STD-348B/321

SMA according to

IEC 60169-15; MIL-STD-348B/310

Electrical Data

Impedance

50 Ω

Frequency

DC to 18 GHz

VSWR (Return Loss)

≤ 1.20 (≥ 21 dB)

Insertion Loss

≤ 0.03 × √F (GHz) dB

Insulation Resistance

≥ 5 GΩ

Operating Voltage(AC)

350 Vrms

Dielectric Withstanding Voltage

1000 Vrms

Material And Plating

Piece Parts (BMMA)	Material	Plating
Centre contact	Beryllium Copper	Gold plating, 3 μinch (Non-magnetic nickel-phosphorus underplating, 80 μinch)
Body	Stainless Steel	Passivated
Insulator	PTFE	
Piece Parts (SMA)	Material	Plating
Centre contact	Beryllium Copper	Gold plating, 3 μinch (Non-magnetic nickel-phosphorus underplating, 80 μinch)
Body	Stainless Steel	Passivated
Insulator	PTFE	

BMMA Jack(female) to SMA Jack(female) Straight Adapter DC-18GHz, VSWR ≤ 1.2

AD-BM2A25A-PT / 9X-9X

Mechanical Data

	BMMA side	SMA side
Coupling mechanisms	Slide-lock	Screw-lock
Mating cycles	≥ 500	≥ 500
Coupling nut retention	N/A	N/A
Center contact captivation: axial	N/A	≥ 200 N
Coupling test torque	N/A	max. 0.6 Nm
Recommended torque	N/A	0.5 Nm
Engagement force	≤ 13.5 N	N/A
Disengagement force	≥ 2 N	N/A

Environmental Data

Temperature range	-65°C to +125°C
RoHS	compliant

Packing

Single or 100