

BMA plug (male) / BMA jack (female) Adaptors Straight DC-18GHz VSWR1.20

AD-BA1BA25A / 9X-9X

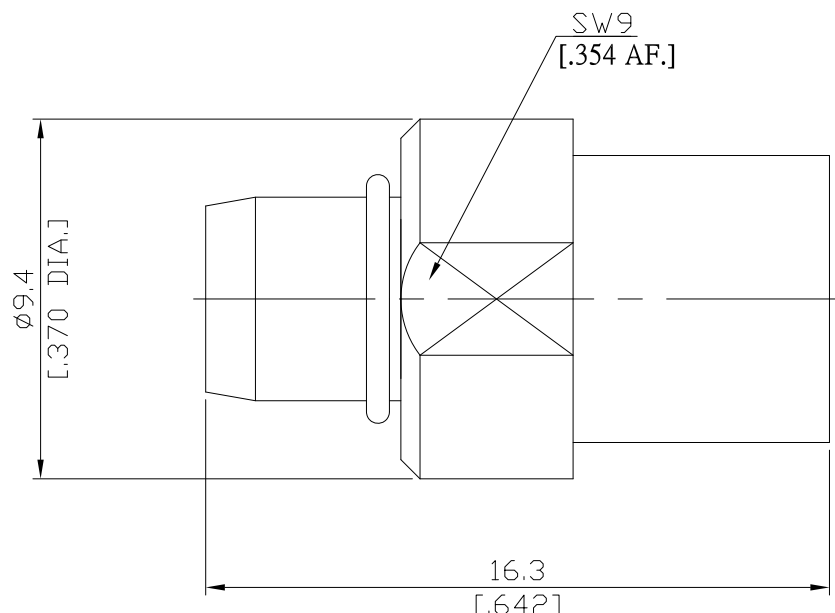

All dimensions are in mm [inch]

Tolerances according to DIN ISO 2768-mH

Interface

Mechanically compatible with

According to

OSP and RPC-SP

IEC 61169-33, MIL-STD-348B/326

Electrical Data

Impedance

Frequency

VSWR (Return Loss)

Insertion Loss

50 Ω

DC to 18 GHz

≤ 1.20 (≥ 20.8 dB)

$\leq 0.05 \times \sqrt{f}$ (GHz) dB

Material And Plating

Piece Parts (BMA)	Material	Plating
Centre contact	Beryllium Copper	Gold plating, 3 μ inch (Non-magnetic nickel-phosphorus underplating, 80 μ inch)
Body	Stainless Steel	Passivated
Insulator	PTFE	
Gasket	Silicone Rubber	
Piece Parts (BMA)	Material	Plating
Centre contact	Beryllium Copper	Gold plating, 3 μ inch (Non-magnetic nickel-phosphorus underplating, 80 μ inch)
Body	Stainless Steel	Passivated
Insulator	PTFE	

BMA plug (male) / BMA jack (female) Adaptors Straight DC-18GHz VSWR1.20

AD-BA1BA25A / 9X-9X

Mechanical Data

Coupling Mechanisms	Slide-on
Mating Cycles	≥ 1000
Center Contact Captivation	≥ 27 N
Engagement Force	≤ 13.5 N
Disengagement Force	≥ 2 N

Environmental Data

Temperature Range	-65°C to +125°C
RoHS	compliant

Packing

Single or 100