

4.3-10 Plug (Male) to DIN 7-16 Jack (Female) Adapter
DC-7.5GHz VSWR1.05

AD-43102D25A / H4-H4

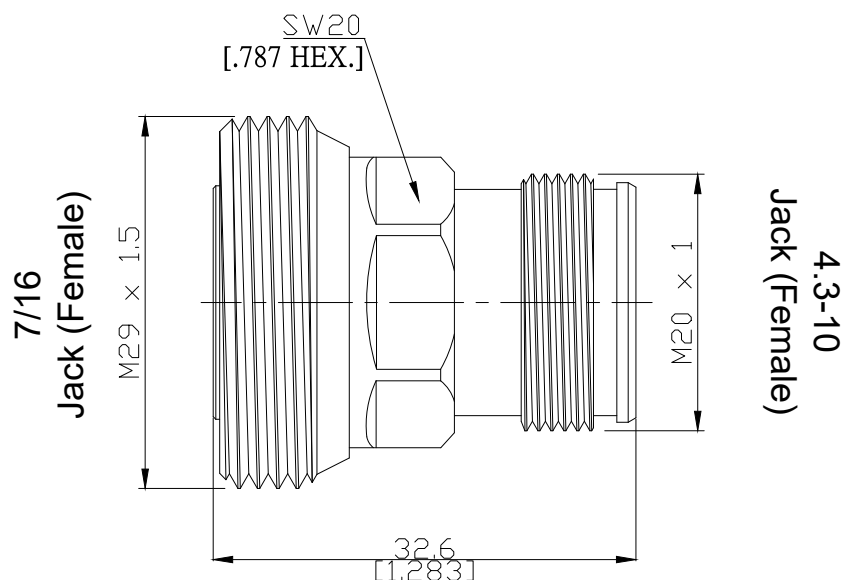

All dimensions are in mm [inch]
Tolerances according to DIN ISO 2768-mH

Interface

According to

4.3-10 Side
IEC 61169-54

7-16 Side
IEC 61169-4

Electrical Data

Impedance	50 Ω	
Frequency	DC to 8.3 GHz	
VSWR (Return Loss)	≤ 1.05 (≥ 32 dB)	
Insertion Loss	≤ 0.03 x √F (GHz) dB	
Insulation Resistance	≥ 5 GΩ	
Center Contact Resistance	≤ 1.0 mΩ, 4.3-10 Side	≤ 0.4 mΩ, 7-16 Side
Outer Contact Resistance	≤ 1.0 mΩ, 4.3-10 Side	≤ 1.5 mΩ, 7-16 Side
Test Voltage (at sea level)	2500 V rms	
Working Voltage (at sea level)	500 V rms	
RF Leakage	≥ 120 dB @ DC to 6 GHz	
Power Handling	500 W @ 2 GHz	
Intermodulation (3rd order)	≥ 166 dBc (2 x 43 dBm) @ 0.4-4.0 GHz	

Material And Plating

Piece Parts (4.3-10)	Material	Plating
Centre Contact	Brass	Gold plating, 3 μinch (Non-magnetic nickel-phosphorus underplating, 80 μinch)
Body	Brass	Copper-Tin-Zinc Alloy
Insulator	PTFE	
Gasket	Silicone Rubber	
Piece Parts (7-16)	Material	Plating
Centre Contact	Phosphor Bronze	Gold plating, 3 μinch (Non-magnetic nickel-phosphorus underplating, 80 μinch)
Body	Brass	Copper-Tin-Zinc Alloy
Insulator	PTFE	

The facts and figures herein are carefully compiled to the best of our knowledge, but they are intended for general informational purposes only. In the effort to improve our products, we reserve the right to make changes judged to be necessary.

Rev.:
Date: 6/23/2019

Rosnol RF/Microwave Technology Co., Ltd.
www.rosnol.com; info@rosnol.com
Phone: +886-3-463-5095 / Fax: +886-3-463-5952
N-CAGE Code: SFKK0 / ISO9001 Certified

Page
1/2

4.3-10 Plug (Male) to DIN 7-16 Jack (Female) Adapter
DC-7.5GHz VSWR1.05

AD-43102D25A / H4-H4

Mechanical Data

	4.3-10 Side	7-16 Side
Coupling mechanisms	Screw-lock	Screw-lock
Mating Cycles	≥ 100	≥ 500
Center Contact Captivation: axial	≥ 30 N	≥ 200 N
radiall	> 5 Ncm	> 2 Ncm
Coupling Nut Retention	≥ 270 N	≥ 270 N
Center Contact Captivation	≥ 20 N	≥ 20 N
Center Contact Retention Force	1.5-20 N	N/A
Recommended Torque	5 Nm	25 Nm
Engagement force	typ. 100 N	N/A
Disengagement force	typ. 80 N	N/A

Environmental Data

Temperature Range	-55°C to +165°C
Thermal shock	IEC 61169-1 9.4.4
Corrosion	ISO 21207 method B
Vibration	IEC 61169-1 9.3.3 and IEC 60068-2-64
Shock	IEC 61169-1 9.3.14
Degree of Protection (Mated Pair)	IEC 60529, IP68 1h / 25m
RoHS	compliant

Packing

Standard	Single
Weight	N/A