

SMPS Plug (male) PCB Surface Mount Connector
Solder Attachment (Full Detent) DC-65GHz

SMPS1N50-FD305A / 99

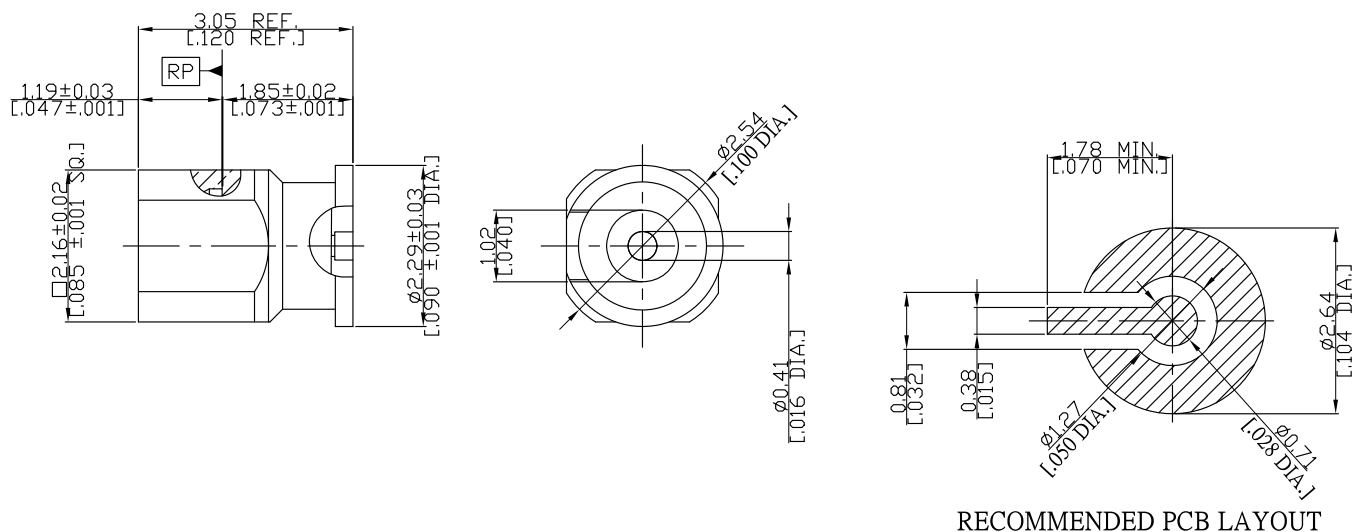

All dimensions are in mm [inch]

Tolerances according to DIN ISO 2768-mH

Interface

According to N/A

Electrical Data

Impedance 50 Ω
Frequency DC to 65 GHz
Insertion loss $\leq 0.12 \times \sqrt{F}$ (GHz) dB

-VSWR in application depends decisive on PCB layout or cavity design-

Mechanical Data

Coupling mechanisms Snap-on
Board mounting type Edge Mount
Weight N/A

Environmental Data

Temperature range -55°C to +125°C
RoHS compliant

Material And Plating

Connector parts	Material	Plating
Centre contact	Beryllium Copper	Gold plating, 3 pinch (Non-magnetic nickel-phosphorus underplating, 80 pinch)
Body	Beryllium Copper	Gold plating, 3 pinch (Non-magnetic nickel-phosphorus underplating, 80 pinch)
Insulator	PTFE	

Packing

Single or 100