

SMP Plug (Male) Smooth Bore Snap-On Connector Solder Attachment
Surface Mount DC-26.5 GHz, VSWR 1.29

SMP1N50-SB410A / 11

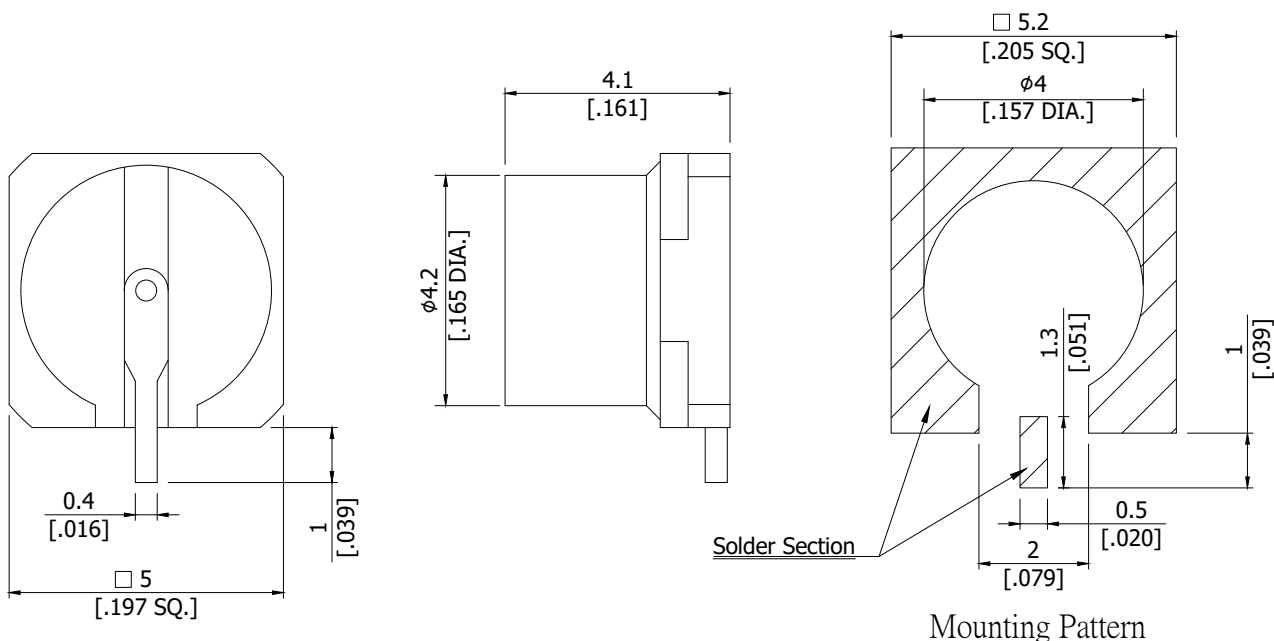

All dimensions are in mm [inch]

Tolerances according to DIN ISO 2768-mH

Interface

According to

MIL-STD-348B/326-1
MIL-STD-348B/326-3
MIL-STD-348B/326-4

MIL-STD-348B/326-1a
MIL-STD-348B/326-2
MIL-STD-348B/326-5

Electrical Data

Impedance	50 Ω
Frequency	DC to 26.5 GHz
VSWR (Return Loss)	≤ 1.29 (≥ 18 dB)
Insertion Loss	≤ 0.1 x √F (GHz) dB
Insulation Resistance	≥ 5 GΩ
Center Contact Resistance	≤ 6.0 mΩ
Outer Contact Resistance	≤ 2.0 mΩ
Test Voltage (at sea level)	500 V rms
Working Voltage (at sea level)	335 V rms

- Connector Only; VSWR in Application Depends Decisive on PCB Layout -

Material And Plating

Piece Parts	Material	Plating
Centre contact	Brass	Gold plating, 3 pinch (Non-magnetic nickel-phosphorus underplating, 80 pinch)
Body	Brass	Gold plating, 3 pinch (Non-magnetic nickel-phosphorus underplating, 80 pinch)
Insulator	PTFE	

The facts and figures herein are carefully compiled to the best of our knowledge, but they are intended for general informational purposes only. In the effort to improve our products, we reserve the right to make changes judged to be necessary.

Rev.: 1.0

Date:
APR/23/2021

Rosnol RF/Microwave Technology Co., Ltd.

www.rosnol.com; info@rosnol.com

Phone: +886-3-463-5095 / Fax: +886-3-463-5952

N-CAGE Code: SFKK0 / ISO9001 Certified

Page

1/2

SMP Plug (Male) Smooth Bore Snap-On Connector Solder Attachment
Surface Mount DC-26.5 GHz, VSWR 1.29

SMP1N50-SB410A / 11

Mechanical Data

Coupling mechanisms	Snap-on	
Mating Cycles	Smooth Bore	≥ 1000
Center contact captivation		≥ 7 N
Engagement Force	Smooth Bore	9 N max.
Disengagement force	Smooth Bore	2.2 N min.

Environmental Data

Temperature Range	-65°C to +155°C
Thermal shock	MIL-STD-202, Meth. 107, Cond. B
Vibration	MIL-STD-202, Meth. 204, Cond. B
Shock	MIL-STD-202, Meth. 213, Cond. A
Moisture Resistance	MIL-STD-202, Meth. 106
Max. Soldering Temperature	IEC 61760-1, +260°C for 10 sec.
RoHS	compliant

Packing

Single or 100