

SMC Jack (female) Connector Solder Attachment  
PCB Through Holes Right Angle, DC-10GHz VSWR1.20

**SMC2I59-1380A / 11**

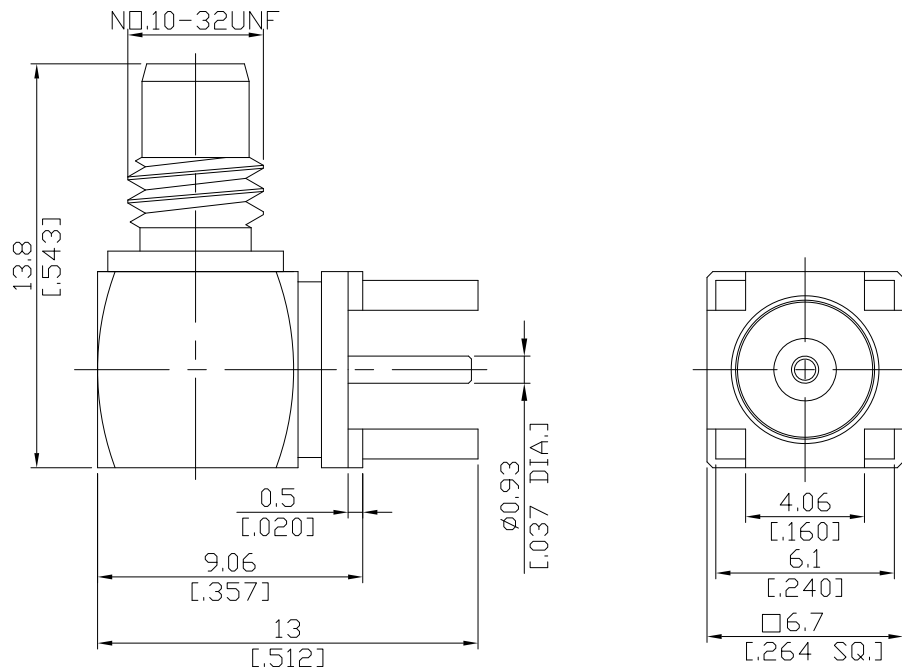

All dimensions are in mm [inch]

Tolerances according to DIN ISO 2768-mH

**Interface**

According to

MIL-C-39012; MIL-STD-348A/312

MIL-STD-348B/312-1-1, MIL-STD-348B/312-2

**Electrical Data**

Impedance

50  $\Omega$

Frequency

DC to 10 GHz

VSWR (Return Loss)

$\leq 1.20$  ( $\geq 20.83$  dB)

Insertion Loss

$\leq 0.05 \times \sqrt{F}$  (GHz) dB

- VSWR in application depends decisive on PCB layout -

**Mechanical Data**

Coupling mechanisms

Screw-lock

Board mounting type

Through Holes

Weight

N/A

**Environmental Data**

Temperature range

-65°C to +165°C

RoHS

compliant

**Material And Plating**

| Connector parts | Material | Plating                          |
|-----------------|----------|----------------------------------|
| Centre contact  | Brass    | Gold plating(Nickel underplated) |
| Body            | Brass    | Gold plating(Nickel underplated) |
| Insulator       | PTFE     |                                  |

**Packing**

Single or 100

**Related Document**

Mounting Dimension

MD89

The facts and figures herein are carefully compiled to the best of our knowledge, but they are intended for general informational purposes only. In the effort to improve our products, we reserve the right to make changes judged to be necessary.

Rev.:-

Date:  
JUL/16/2021

Rosnol RF/Microwave Technology Co., Ltd.

[www.rosnol.com](http://www.rosnol.com); [info@rosnol.com](mailto:info@rosnol.com)

Phone: +886-3-463-5095 / Fax: +886-3-463-5952

N-CAGE Code: SFKK0 / ISO9001 Certified

Page

1/1