

SMB Jack (female) Connector Solder Attachment
PCB Through Holes Straight, DC-4GHz VSWR1.29

SMB2I50-1195A / 11

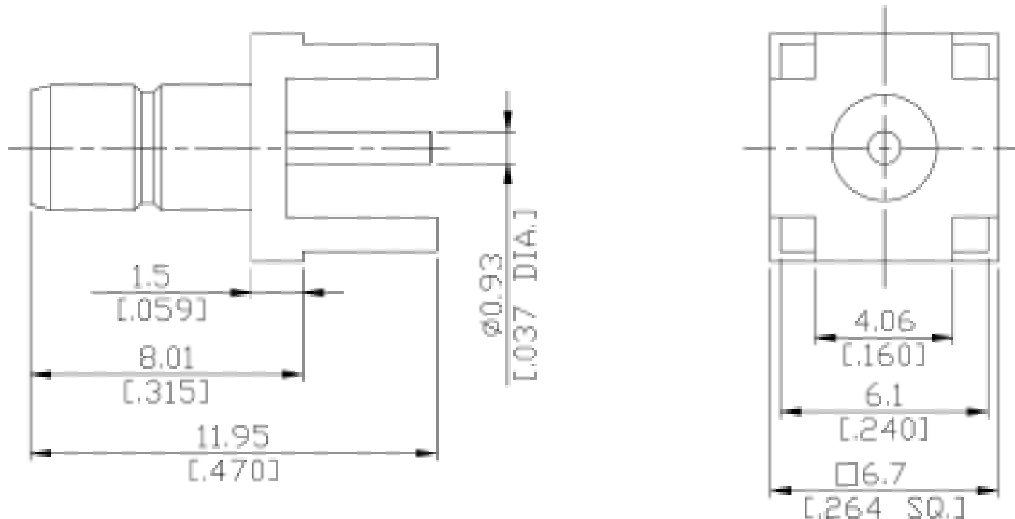

All dimensions are in mm [inch]

Tolerances according to DIN ISO 2768-mH

Interface

According to

IEC 60169-10, CECC 22130

MIL-STD-348B/311-1, MIL-STD-348B/311-1

Electrical Data

Impedance

50 Ω

Frequency

DC to 4 GHz

VSWR (Return Loss)

≤ 1.29 (≥ 18 dB)

3 to 4 GHz

Insertion Loss

≤ 0.1 × √F (GHz) dB

Insulation Resistance

≥ 1 × 10³ MΩ

Center Contact Resistance

≤ 5 mΩ

Outer Contact Resistance

≤ 2.5 mΩ

Test Voltage

750 V rms, 50 Hz, at sea level

Working Voltage (at sea level)

≤ 250 V rms, 50 Hz, at sea level

Contact current

1.5 A DC typ.

RF-leakage

≤ 55 dB up to 1 GHz

Material And Plating

| Connector parts | Material | Plating |
|-----------------|----------|----------------------------------|
| Centre contact | Brass | Gold plating(Nickel underplated) |
| Body | Brass | Gold plating(Nickel underplated) |
| Insulator | PTFE | |

SMB Jack (female) Connector Solder Attachment PCB Through Holes Straight, DC-4GHz VSWR1.29

SMB2I50-1195A / 11

Mechanical Data

| | |
|-----------------------------------|-----------------------|
| Coupling mechanisms | Snap-on |
| Mating Cycles | ≥ 500 |
| Centre Contact | Soldered |
| Captivated Type | Mechanical |
| Center Contact Captivation: axial | ≥ 27 N |
| Engagement force | ≥ 63 N |
| Disengagement force | 8 N min. to 63 N max. |

Environmental Data

| | |
|----------------------------|---------------------------------|
| Temperature Range | -55°C to +155°C |
| Thermal shock | MIL-STD-202, Meth. 107, Cond. B |
| Corrosion | MIL-STD-202, Meth. 101, Cond. B |
| Vibration | MIL-STD-202, Meth. 204, Cond.D |
| Moisture Resistance | MIL-STD-202, Meth. 106 |
| Max. soldering temperature | IEC 61760-1, +260°C for 10 sec. |
| RoHS | compliant |

Packing

Single or 100