

SMB Jack (Female) Connector Solder Attachment Thru Hole PCB, 5.08mm (.200")  
hole Spacing, DC-4 GHz, VSWR 1.3

**SMB2I50-1143A / 11**

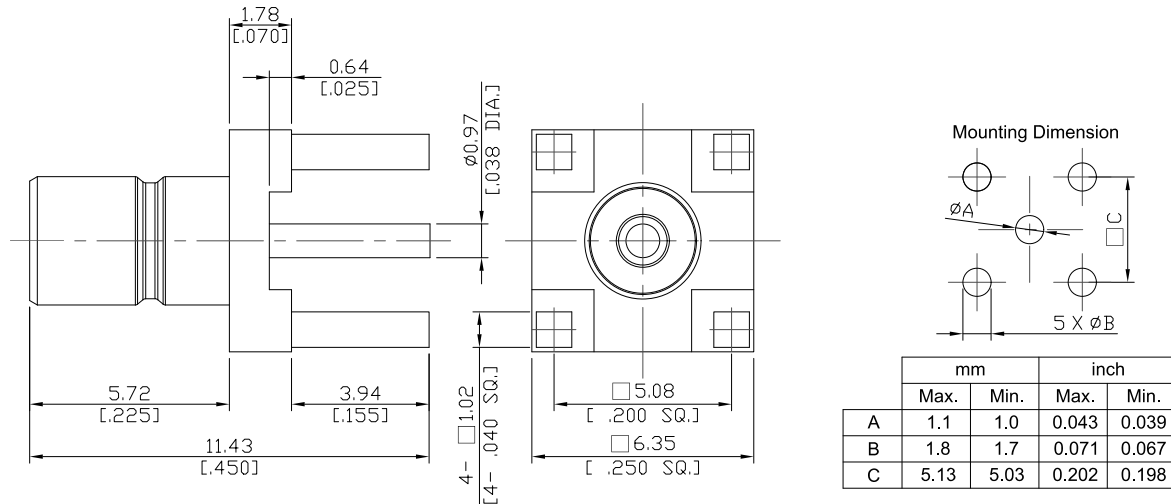

All dimensions are in mm [inch]

Tolerances according to DIN ISO 2768-mH

**Interface**

According to

MIL-STD-348B/311; IEC 61169-10; MIL-PRF-39012 ; CECC 22130

**Electrical Data**

Impedance	50 Ω
Frequency	DC to 4 GHz
VSWR (Return Loss)	≤ 1.3 (≥ 17.69 dB)
Insertion Loss	≤ 0.1 × √f (GHz) dB
Insulation Resistance	≥ 1x10 <sup>3</sup> MΩ
Center Contact Resistance	≤ 5 mΩ
Outer Contact Resistance	≤ 2.5 mΩ
Test Voltage (at sea level)	750 V rms
Working Voltage (at sea level)	≤ 250 V rms
RF-leakage	≥ 55 dB up to 1 GHz

-VSWR in application depends decisive on PCB layout or cavity design-

**Material And Plating**

Piece Parts	Material	Plating
Centre contact	Brass	Gold plating (Non-magnetic nickel-phosphorus underplating)
Body	Brass	Gold plating (Non-magnetic nickel-phosphorus underplating)
Insulator	PTFE	

SMB Jack (Female) Connector Solder Attachment Thru Hole PCB, 5.08mm (.200")  
hole Spacing, DC-4 GHz, VSWR 1.3

**SMB2I50-1143A / 11**

**Mechanical Data**

Coupling mechanisms	Snap-On
Mating cycles	≥ 500
Center contact captivation: axial	≥ 10 N
Engagement force	≤ 63 N
Disengagement force	8 N min. to 63 N max.

**Environmental Data**

Temperature Range	-65°C to +165°C
Thermal shock	MIL-STD-202, Meth. 107, Cond. B
Corrosion	MIL-STD-202, Meth. 101, Cond. B
Vibration	MIL-STD-202, Meth. 204, Cond. B
Moisture Resistance	MIL-STD-202, Meth. 106
RoHS	compliant

**Packing**

Single or 100