

Reverse Polarity SMA (RP male) PCB Through Holes Straight Plug DC-18 GHz

SMA5I50-1680A / 911

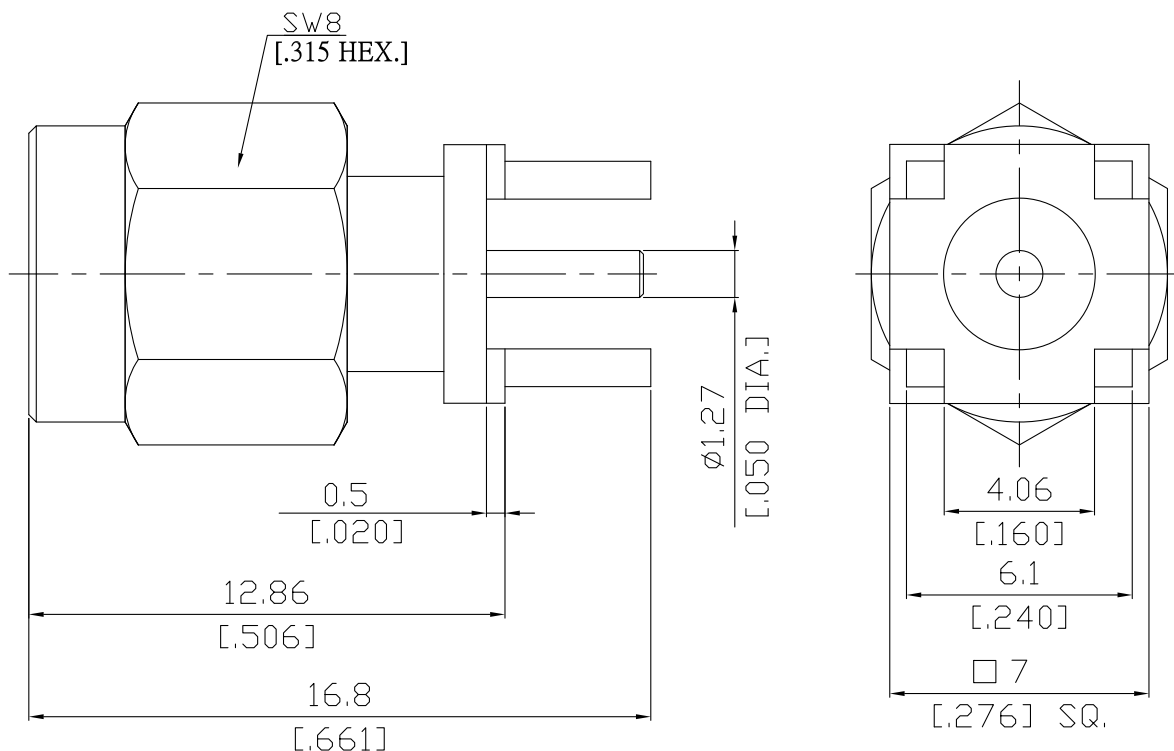

All dimensions are in mm [inch]

Tolerances according to DIN ISO 2768-mH

Interface

Derived from

IEC 60169-15; MIL-STD-348B/310

Electrical Data

| | |
|--------------------------------|--------------------------------------|
| Impedance | 50 Ω |
| Frequency | DC to 18 GHz |
| VSWR (Return Loss) | $\leq 1.15 + .015F$ (GHz) |
| Insertion Loss | $\leq 0.04 \times \sqrt{F}$ (GHz) dB |
| Insulation Resistance | ≥ 5 G Ω |
| Center Contact Resistance | ≤ 3 m Ω |
| Outer Contact Resistance | ≤ 3 m Ω |
| Test Voltage (at sea level) | 1000 V rms |
| Working Voltage (at sea level) | 480 V rms |

- Electrical performance guaranteed for connector only -

Material And Plating

| Connector parts | Material | Plating |
|-----------------|------------------|--|
| Centre contact | Beryllium Copper | Gold plating, 3 μ inch (Non-magnetic nickel-phosphorus underplating, 80 μ inch) |
| Body | Brass | Gold plating, 3 μ inch (Non-magnetic nickel-phosphorus underplating, 80 μ inch) |
| Insulator | PTFE | |
| Gasket | Silicone Rubber | |
| Coupling nut | Brass | Gold plating, 3 μ inch (Non-magnetic nickel-phosphorus underplating, 80 μ inch) |

Reverse Polarity SMA (RP male) PCB Through Holes Straight Plug DC-18 GHz

SMA5I50-1680A / 911

Mechanical Data

| | |
|-----------------------------------|---------------|
| Coupling mechanisms | Screw-lock |
| Mating Cycles | ≥ 500 |
| Center Contact Captivation: axial | ≥ 27 N |
| Coupling Test Torque | 1.7 Nm max. |
| Recommended Torque | 0.90 Nm |
| Board mounting type | Through Holes |

Environmental Data

| | |
|---------------------|---------------------------------|
| Temperature Range | -65°C to +165°C |
| Thermal shock | MIL-STD-202, Meth. 107, Cond. B |
| Corrosion | MIL-STD-202, Meth. 101, Cond. B |
| Vibration | MIL-STD-202, Meth. 204, Cond. D |
| Shock | MIL-STD-202, Meth. 213, Cond. I |
| Moisture Resistance | MIL-STD-202, Meth. 106 |
| RoHS | compliant |

Packing

Single or 100