

SMA Plug (male) PCB Through Holes Straight Connector  
DC-18GHz VSWR1.25

**SMA1I50-1680A / 111**

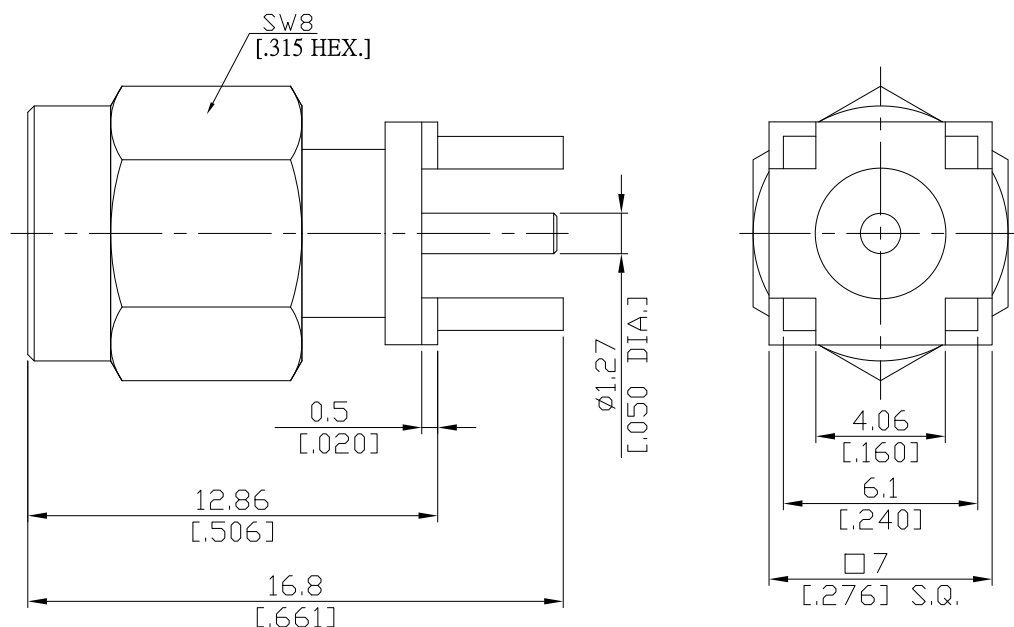

All dimensions are in mm [inch]

Tolerances according to DIN ISO 2768-mH

**Interface**

According to

IEC 60169-15; MIL-STD-348B/310

**Electrical Data**

Impedance

50  $\Omega$

Frequency

DC to 18 GHz

VSWR (Return Loss)

$\leq 1.25$  ( $\geq 19.1$  dB)

Insertion Loss

$\leq 0.04 \times \sqrt{f}$  (GHz) dB

Insulation Resistance

$\geq 5$  G $\Omega$

Center Contact Resistance

$\leq 3$  m $\Omega$

Outer Contact Resistance

$\leq 2$  m $\Omega$

Test Voltage

1000 V rms

Working Voltage (at sea level)

480 V rms

Power Handling (at 20 °C, sea level, VSWR 1.0)

$\leq 200$  W @ 2 GHz;  $\leq 100$  W @ 10 GHz

RF-leakage

100 dB up to 1 GHz

**Material And Plating**

Connector parts	Material	Plating
Centre contact	Brass	Gold plating, 3 $\mu$ inch (Non-magnetic nickel-phosphorus underplating, 80 $\mu$ inch)
Body	Brass	Gold plating, 3 $\mu$ inch (Non-magnetic nickel-phosphorus underplating, 80 $\mu$ inch)
Insulator	PTFE	
Gasket	Silicone Rubber	
Coupling nut	Brass	Gold plating, 3 $\mu$ inch (Non-magnetic nickel-phosphorus underplating, 80 $\mu$ inch)

SMA Plug (male) PCB Through Holes Straight Connector  
DC-18GHz VSWR1.25

**SMA1I50-1680A / 111**

**Mechanical Data**

Coupling mechanisms	Screw-lock
Mating cycles	min. 500
Center contact captivation: axial	≥ 27 N
Board mounting type	Through Holes
Coupling test torque	max. 1.7 Nm
Recommended torque	0.8 Nm to 1.1 Nm

**Environmental Data**

Temperature Range	-65°C to +165°C
Thermal shock	MIL-STD-202, Meth. 107, Cond. B
Corrosion	MIL-STD-202, Meth. 101, Cond. B
Vibration	MIL-STD-202, Meth. 204, Cond. D
Shock	MIL-STD-202, Meth. 213, Cond. I
Moisture Resistance	MIL-STD-202, Meth. 106
RoHS	compliant

**Packing**

Single or 100