

# MMCX Jack(female) PCB Through Holes Right Angle

## MMCX2I59-0650A / 91

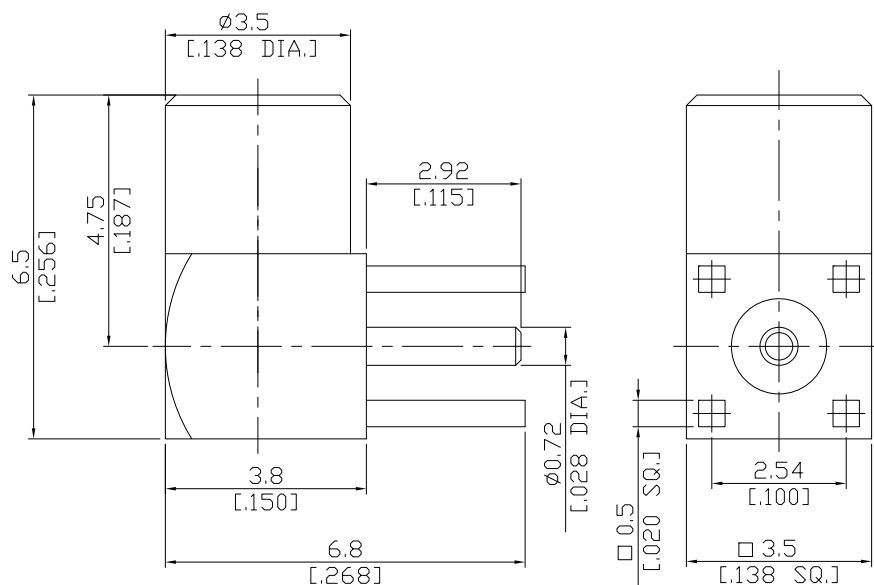

All dimensions are in mm [inch]

### Interface

According to N/A

### Electrical Data

Impedance 50  $\Omega$   
Frequency DC to 6 GHz

### Mechanical Data

Coupling mechanisms Snap-lock  
Board mounting type Through Holes  
Weight 0.0005 kg

### Environmental Data

Temperature range -55°C to +155°C  
RoHS compliant

### Material And Plating

Connector parts	Material	Plating
Centre contact	Beryllium Copper	Gold plating(Nickel underplated)
Body	Brass	Gold plating(Nickel underplated)
Insulator	PTFE	

### Packing

Single or 100

### Related Document

Mounting Dimension MD91