

## MMCX Jack(female) PCB Through Holes Straight

### MMCX2I50-0750A / H1

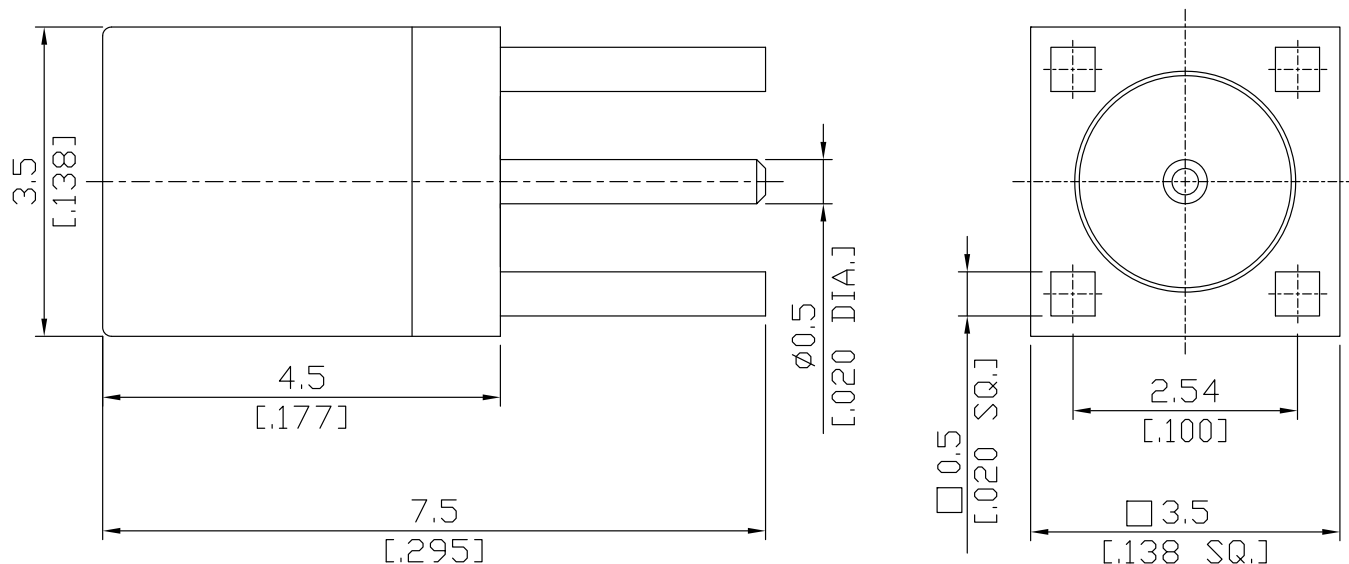

All dimensions are in mm [inch]

#### Interface

According to N/A

#### Electrical Data

Impedance 50  $\Omega$   
Frequency DC to 6 GHz

#### Mechanical Data

Coupling mechanisms Snap-lock  
Board mounting type Through Holes  
Weight 0.0003 kg

#### Environmental Data

Temperature range -55°C to +155°C  
RoHS compliant

#### Material And Plating

Connector parts	Material	Plating
Centre contact	Phosphor Bronze	Gold plating(Nickel underplated)
Body	Brass	Gold plating(Nickel underplated)
Insulator	PTFE	

#### Packing

Single or 100

#### Related Document

Mounting Dimension MD91