

MMCX Jack(female) PCB Through Holes Straight

MMCX2I50-0530A / H1

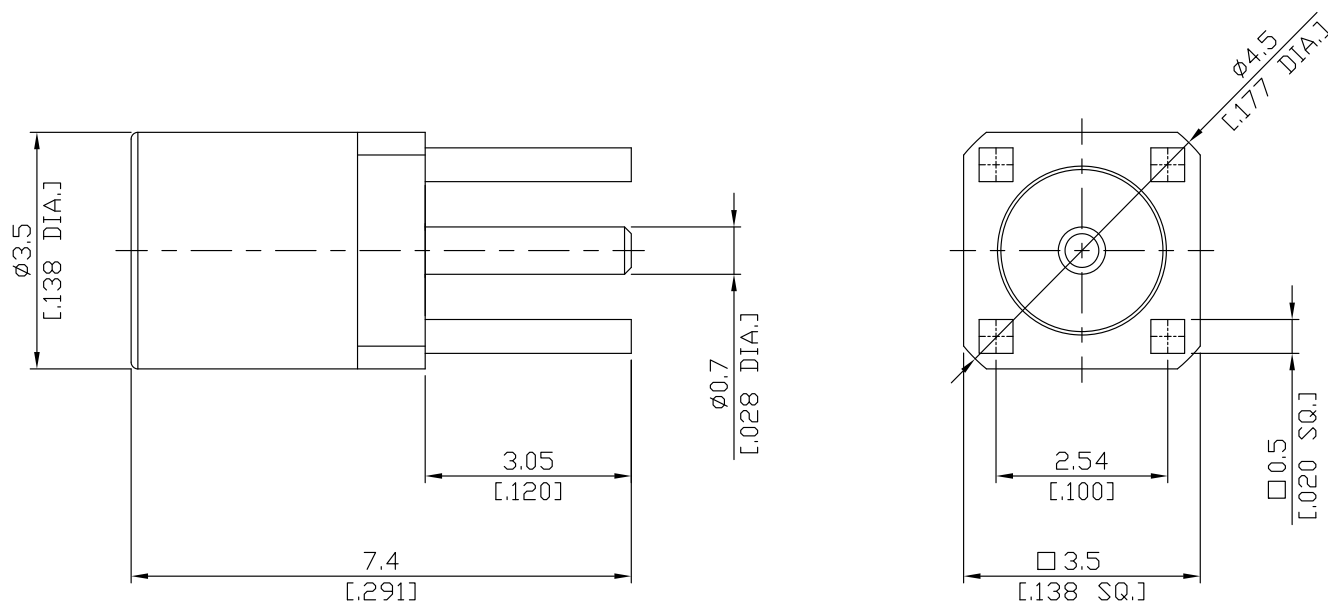

All dimensions are in mm [inch]

Interface

According to N/A

Electrical Data

Impedance 50 Ω
Frequency DC to 6 GHz

Mechanical Data

Coupling mechanisms Snap-lock
Board mounting type Through Holes
Weight 0.0005 kg

Environmental Data

Temperature range -55°C to +155°C
RoHS compliant

Material And Plating

| Connector parts | Material | Plating |
|-----------------|------------------|----------------------------------|
| Centre contact | Beryllium Copper | Gold plating(Nickel underplated) |
| Body | Brass | Gold plating(Nickel underplated) |
| Insulator | PTFE | |

Packing

Single or 100

Related Document

Mounting Dimension MD91