

## 2.92mm Bulkhead Jack (Female) End Launch Connector

### K2HA50BH-2512A / 9X

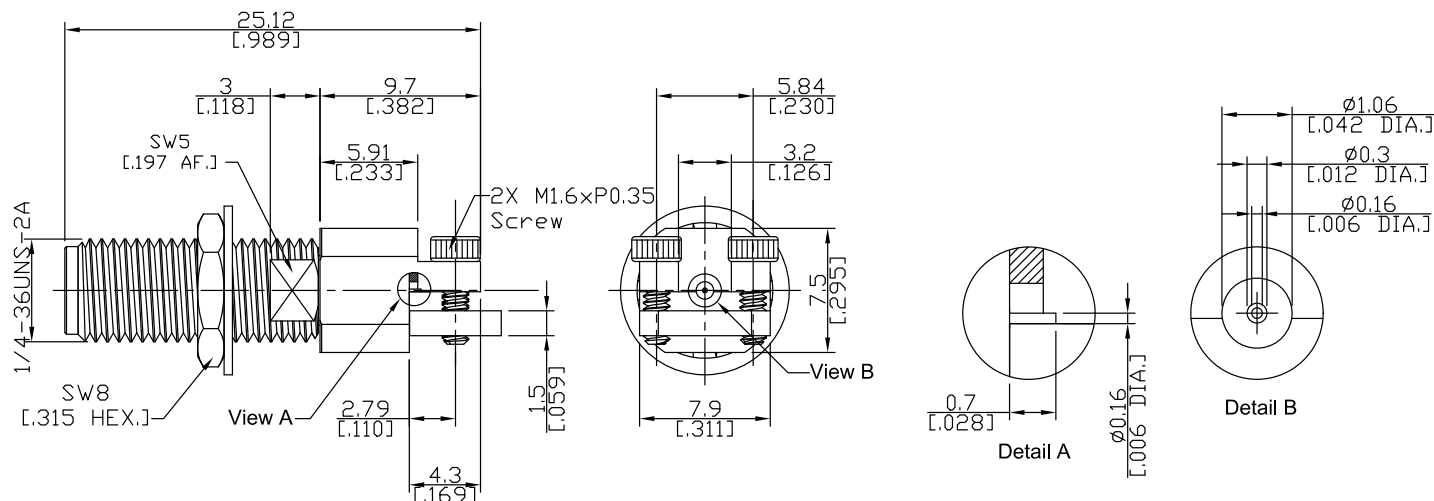

All dimensions are in mm [inch]

Tolerances according to DIN ISO 2768-mH

#### Interface

According to

IEC 61169-35; IEEE Std 287

#### Electrical Data

Impedance	50 Ω
Frequency	DC to 40 GHz
VSWR (Return Loss)	≤ 1.40 (≥ 15.56 dB)
Insertion Loss	≤ 0.04 x √F (GHz) dB
Insulation Resistance	≥ 5 GΩ
Test Voltage	750 V rms
Working voltage	250 V rms

- Return loss in application depends decisive on PCB layout -

#### Material And Plating

Connector parts	Material	Plating
Centre contact	Beryllium Copper	Gold plating (Non-magnetic nickel-phosphorus underplating)
Body	Stainless Steel	Passivated
Insulator	PEI	
Fastening nut	Brass	Copper-Tin-Zinc Alloy
Washer	Brass	Copper-Tin-Zinc Alloy

## 2.92mm Bulkhead Jack (Female) End Launch Connector

### K2HA50BH-2512A / 9X

#### Mechanical Data

Coupling mechanisms	Screw-lock
Mating Cycles 2.92mm side	≥ 500
Board mounting type	End Launch
Center Contact Captivation: axial	≥ 20 N
Coupling Test Torque	1.7 Nm
Recommended Torque	0.80 Nm to 1.10 Nm
Recommended torque screw 1.6	0.20 Nm to 0.30 Nm

#### Environmental Data

Temperature Range	-55°C to +85°C
Thermal shock	MIL-STD-202, Method 107, Condition B
Corrosion	MIL-STD-202, Method 101, Condition B
Vibration	MIL-STD-202, Method 204, Condition D
Shock	MIL-STD-202, Method 213, Condition I
Moisture Resistance	MIL-STD-202, Method 106
RoHS	compliant

#### Packing

Single or 100