

SMA plug (male) to SMA Jack (Female)  
Fixed Attenuator 2 Watt DC-15GHz VSWR1.35

**FA-A1A25B-15G2W20 / 9XX-9X**

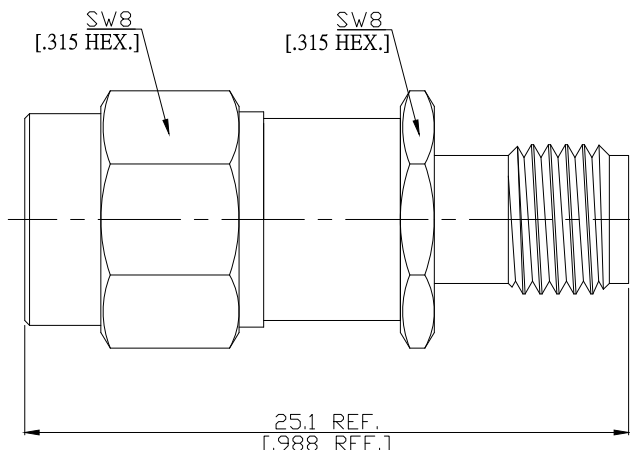

All dimensions are in mm [inch]

Tolerances according to DIN ISO 2768-mH

**Interface**

According to

IEC 61169-15; MIL-STD-348B/310

**Electrical Data**

Impedance

50  $\Omega$

Frequency

DC to 15 GHz

VSWR (Return Loss)

$\leq 1.35$  ( $\geq 16.5$  dB)

Power handling

2 watts average to 25°C

(5  $\mu$ Sec Pulse, 0.05% Duty Cycle)

PEAK: 250 WATTS

**Maximum Deviation Over Frequency**

Nominal ATTN (dB)	Deviation (dB)
20 , 30	$\pm 0.75$

**Mechanical Data**

Coupling mechanisms

Screw-lock

Mating Cycles

$\geq 500$

**Environmental Data**

Temperature Range

-65°C to +125°C

RoHS

compliant

**Material And Plating**

Piece Parts (SMA)	Material	Plating
Centre contact	Beryllium Copper	Gold plating, 3 $\mu$ inch (Non-magnetic nickel-phosphorus underplating, 80 $\mu$ inch)
Body	Stainless Steel	Passivated
Insulator	PTFE	
Gasket	Silicone Rubber	
Coupling nut	Stainless Steel	Passivated
Piece Parts (SMA)	Material	Plating
Centre contact	Beryllium Copper	Gold plating, 3 $\mu$ inch (Non-magnetic nickel-phosphorus underplating, 80 $\mu$ inch)
Body	Stainless Steel	Passivated
Insulator	PTFE	

**Packing**

Single or 100