

**UHF (Female) Straight Cable Jack,
DC-300 MHz**

UHF2CN0-G142A/H3

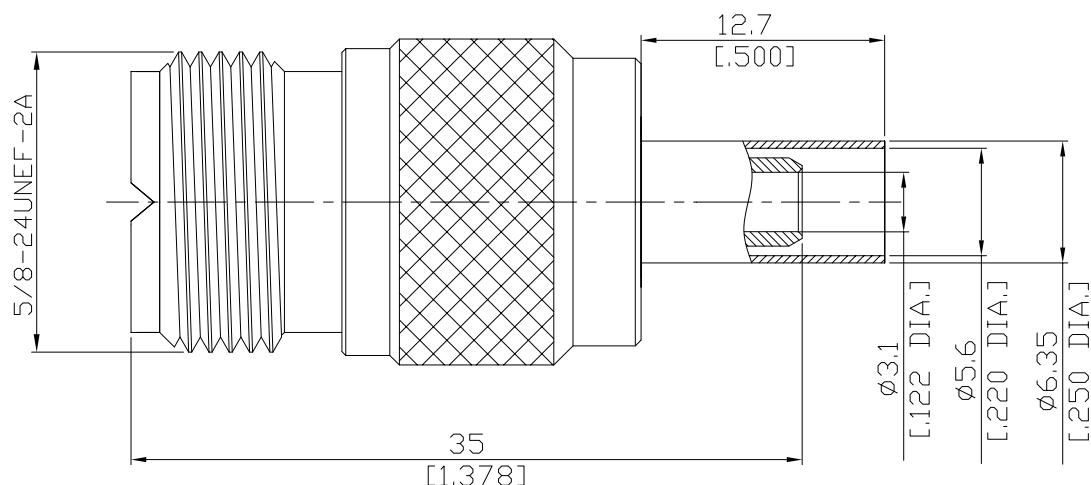

All dimensions are in mm [inch]

Tolerances according to DIN ISO 2768-mH

Interface

According to IEC 60169-12

Electrical Data

Impedance non-constant
Frequency DC to 300 MHz

- Limitations are possible due to the used cable type and manufacturing process -

Mechanical Data

Coupling mechanisms Screw-lock
Centre contact Soldered or Crimped
Cable entry Crimped

Environmental Data

Temperature range -55°C to +149°C
RoHS compliant

Material And Plating

Connector parts	Material	Plating
Centre contact	Phosphor Bronze	Gold plating(Nickel underplated)
Body	Brass	Nickel
Insulator	PTFE	
Crimp ferrules	Brass	Nickel

Suitable Cables

RG-55, RG-142, RG-223, RG-400

Packing

Single, 5-pack, or 100

UHF (Female) Straight Cable Jack,
DC-300 MHz

UHF2CN0-G142A/H3

Recommended Cable Stripping Dimensions

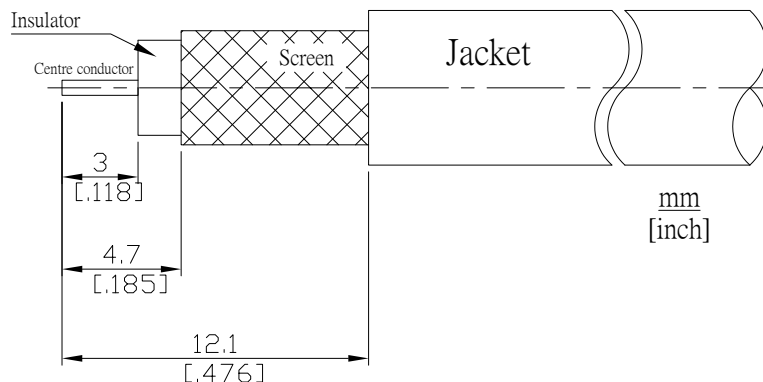

Crimp Dimensions [HEX]

Crimp ferrule	5.41 mm [0.213 inch]
Centre contact	1.73 mm [0.068 inch]