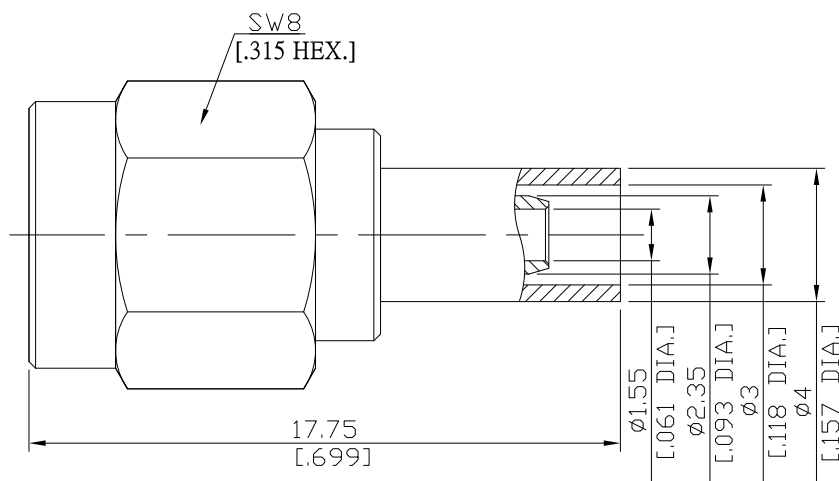

**Rosnol**

Excellence in RF/Microwave Solutions

Technical Data Sheet**SMA Reverse Straight Cable Plug****SMA5C50-G316A/9XX**

All dimensions are in mm [inch]

Interface

According to

MIL-C-39012; MIL-STD-348A/310

Electrical Data

Impedance

50 Ω

Frequency

DC to 18 GHz

*- Limitations are possible due to the used cable type -***Mechanical Data**

Coupling mechanisms

Screw-lock

Centre contact

Soldered

Cable entry

Crimped

Environmental Data

Temperature range

-65°C to +165°C

RoHS

compliant

Material And Plating

Connector parts	Material	Plating
Centre contact	Beryllium Copper	Gold plating(Nickel underplated)
Body	Stainless Steel	Passivated
Insulator	PTFE	
Gasket	Silicone Rubber	
Coupling nut	Stainless Steel	Passivated
Crimp ferrules	Brass	Copper-Tin-Zinc Alloy

Suitable Cables

RG 316/U, RG 174 A/U, RG 188, G 02232, BELDEN 7805

Packing

Single or 100

The facts and figures herein are carefully compiled to the best of our knowledge, but they are intended for general informational purposes only. In the effort to improve our products, we reserve the right to make changes judged to be necessary.

Rev.:-

Date:
19/11/10

Rosnol RF/Microwave Technology
www.rosnol.com ; info@rosnol.com
 Phone:+886-3-463-5095
 Fax:+886-3-463-5952

Page

1/1