

**SMA Jack (Female) Bulkhead Mount Connector Solder Attachment for .141 Cable,  
.232 inch D Hole, DC-18GHz VSWR1.25**

**SMA2EA50-0141D / 9Q**

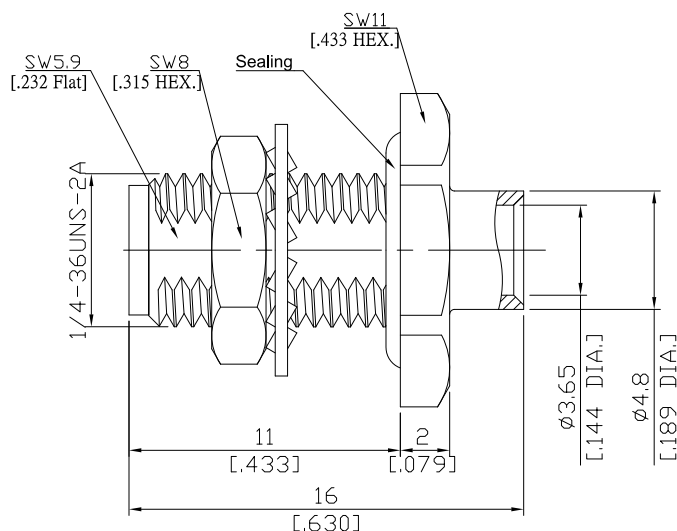

Mounting Dimension

	mm		inch	
	Max.	Min.	Max.	Min.
A	6.5	6.4	.256	.252
B	6.15	6.0	.242	.236

All dimensions are in mm [inch]

Tolerances according to DIN ISO 2768-mH

**Interface**

According to

IEC 60169-15; CECC 22110; MIL-PRF-39012 SMA; MIL-STD-348/310

**Electrical Data**

Impedance	50 Ω
Frequency	DC to 18 GHz
VSWR (Return Loss)	≥ 1.25 (≥ 19.08 dB)
Insertion Loss	≤ 0.03 × √F (GHz) dB
Insulation Resistance	≥ 5 GΩ
Center Contact Resistance	≤ 3 mΩ
Outer Contact Resistance	≤ 2 mΩ
Test Voltage	1000 V rms
Working Voltage	480 V rms
RF leakage	≥ 100 dB up to 1 GHz
Power handling (at 20 °C, sea level, VSWR 1.0)	≤ 200 W @ 2 GHz

-VSWR in application depends decisive on cable assembly process-

**Material And Plating**

Connector parts	Material	Plating
Centre contact	Beryllium Copper	Gold plating (Non-magnetic nickel-phosphorus underplating)
Body	Stainless Steel	Gold plating (Non-magnetic nickel-phosphorus underplating)
Insulator	PTFE	
Coupling nut	Brass	Gold plating (Non-magnetic nickel-phosphorus underplating)
Washer	Brass	Gold plating (Non-magnetic nickel-phosphorus underplating)

The facts and figures herein are carefully compiled to the best of our knowledge, but they are intended for general informational purposes only. In the effort to improve our products, we reserve the right to make changes judged to be necessary.

Rev.:  
Date:  
FEB/8/2025

Rosnol RF/Microwave Technology Co., Ltd.  
[www.rosnol.com](http://www.rosnol.com); [info@rosnol.com](mailto:info@rosnol.com)  
Phone: +886-3-463-5095 / Fax: +886-3-463-5952  
N-CAGE Code: SFKK0 / ISO9001 Certified

Page  
1/2

**SMA Jack (Female) Bulkhead Mount Connector Solder Attachment for .141 Cable,  
.232 inch D Hole, DC-18GHz VSWR1.25**

**SMA2EA50-0141D / 9Q**

**Mechanical Data**

Coupling Mechanisms	Screw-Lock
Mating Cycles	≥ 500
Coupling Test Torque	max. 1.7 Nm
Recommended Torque	0.8 Nm to 1.1 Nm
Centre Contact	Soldered
Cable Entry	Soldered

**Environmental Data**

Temperature Range	-65°C to +165°C
Thermal Shock	MIL-STD-202, Method 107, Condition B
Corrosion	MIL-STD-202, Method 101, Condition B
Vibration	MIL-STD-202, Method 204, Condition D
Shock	MIL-STD-202, Method 213, Condition I
Moisture Resistance	MIL-STD-202, Method 106
RoHS	compliant

**Suitable Cables**

RSR-141, RSF-141, RSF-141-FEP, UT 141, RG 402/U, RTK- FS 141, RTK- Flex 402,  
BELDEN 1673A

**Packing**

Single or 100