

## SMA(Female) Straight Cable Jack

SMA2C50-R240A/H4

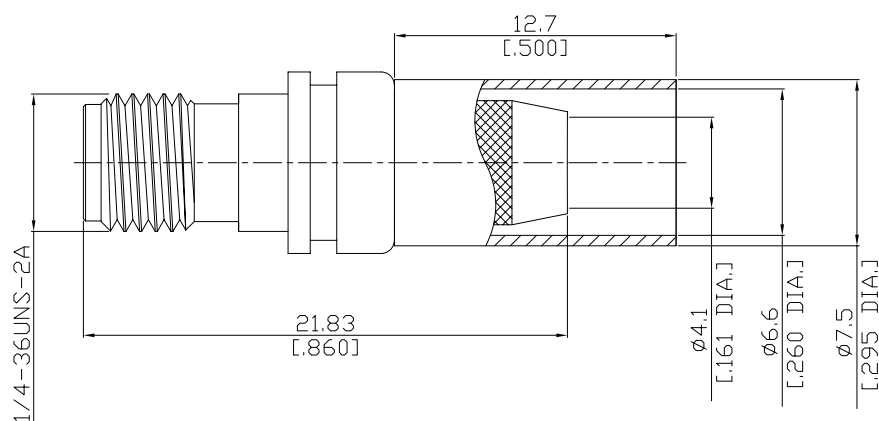

All dimensions are in mm [inch]

Tolerances according to DIN ISO 2768-mH

## Interface

According to

IEC 60169-15; MIL-STD-348A/310

## Electrical Data

## Impedance

 $50\ \Omega$ 

Frequency

DC to 6 GHz

VSWR (Return Loss)

 $\leq 1.30$  ( $\geq 17.69$  dB)

Insertion Loss

$$\leq 0.05 \times \sqrt{F \text{ (GHz)}} \text{ dB}$$

- Limitations are possible due to the used cable type and manufacturing process -

## Mechanical Data

## Coupling mechanisms

### Screw-lock

Centre contact

Soldered or Crimped

Cable entry

Crimped

## Environmental Data

Temperature range

-65°C to +165°C

RoHS

compliant

## Material And Plating

Connector parts	Material	Plating
Centre contact	Phosphor Bronze	Gold plating(Nickel underplated)
Body	Brass	Copper-Tin-Zinc Alloy
Insulator	PTFE	
Crimp ferrules	Brass	Copper-Tin-Zinc Alloy

## Suitable Cables

LMR 240, BELDEN 7808A, BELDEN 9258, BELDEN H155, RNL-240

## Packing

Single or 100

SMA(Female) Straight Cable Jack

SMA2C50-R240A/H4

Cable Stripping Dimensions

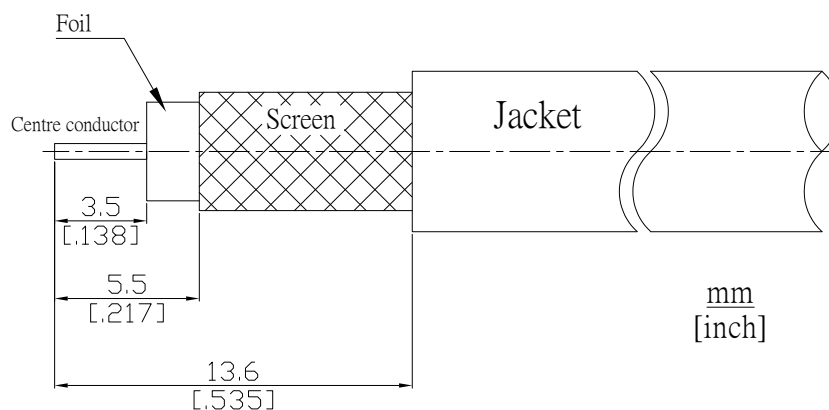

Crimp Dimensions [HEX]

Crimp ferrule	6.48mm [.255 inch]
Centre contact	1.73mm [.068 inch]