

SMA Straight Cable Plug

SMA1E50-0141A/1XX

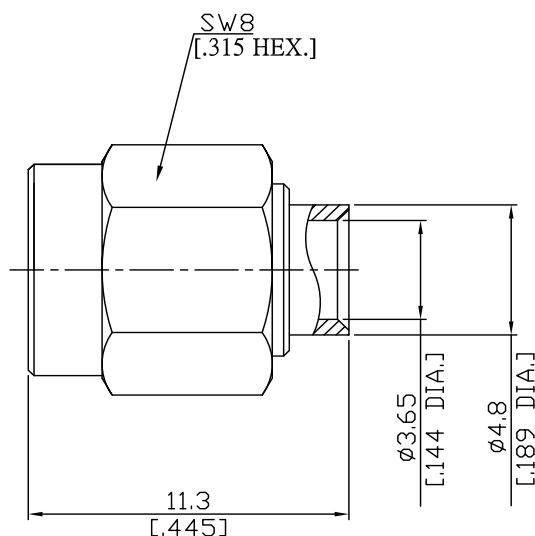

All dimensions are in mm [inch]

Tolerances according to DIN ISO 2768-mH

**Interface**

According to

IEC 60169-15; MIL-C-39012; MIL-STD-348A/310

**Electrical Data**

Impedance

50 Ω

Frequency

DC to 18 GHz

VSWR (Return Loss)

≤ 1.20 (≥ 20.83 dB)

Insertion Loss

≤ 0.05 × √F [GHz] dB

- Limitations are possible due to the used cable type and manufacturing process -

**Mechanical Data**

Coupling mechanisms

Screw-lock

Centre contact

Soldered

Cable entry

Soldered

**Environmental Data**

Temperature range

-65°C to +165°C

RoHS

compliant

**Material And Plating**

Connector parts	Material	Plating
Centre contact	Brass	Gold plating(Nickel underplated)
Body	Stainless Steel	Passivated
Insulator	PTFE	
Gasket	Silicone Rubber	
Coupling nut	Stainless Steel	Passivated

**Suitable Cables**

RSR-141, RSF-141, RSF-141-FEP, EF402, UT 141, RG 402/U, RTK- FS 141, RTK- Flex 402, BELDEN 1673A

**Packing**

Single or 100