

SMA Straight Cable Plug

SMA1E50-0141A/1QX

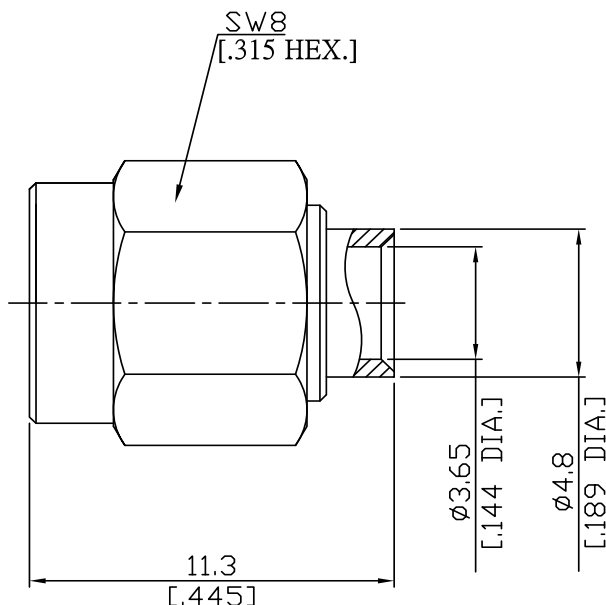

All dimensions are in mm [inch]

Tolerances according to DIN ISO 2768-mH

Interface

According to IEC 60169-15; MIL-C-39012; MIL-STD-348A/310

Electrical Data

Impedance 50 Ω
Frequency DC to 18 GHz
VSWR (Return Loss) ≤ 1.20 (≥ 20.83 dB)
Insertion Loss ≤ 0.05 x √F [GHz] dB

- Limitations are possible due to the used cable type and manufacturing process -

Mechanical Data

Coupling mechanisms Screw-lock
Centre contact Soldered
Cable entry Soldered

Environmental Data

Temperature range -65°C to +165°C
RoHS compliant

Material And Plating

| Connector parts | Material | Plating |
|-----------------|-----------------|----------------------------------|
| Centre contact | Brass | Gold plating(Nickel underplated) |
| Body | Stainless Steel | Gold plating(Nickel underplated) |
| Insulator | PTFE | |
| Gasket | Silicone Rubber | |
| Coupling nut | Stainless Steel | Passivated |

Suitable Cables

RSR-141, RSF-141, RSF-141-FEP, UT 141, RG 402/U, RTK- FS 141, RTK- Flex 402, BELDEN 1673A

Packing

Single or 100