

**SMA Plug (Male) Connector Bulkhead Crimp Attachment RG-178**  
**DC-6 GHz VSWR1.2**

**SMA1CA50-G178B / 133**

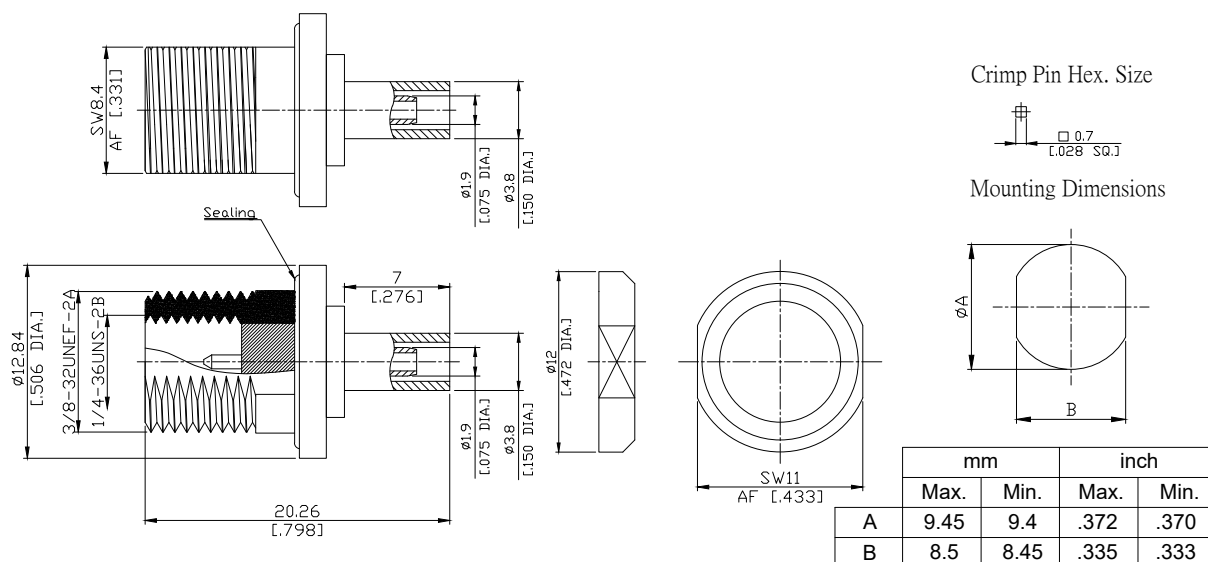

All dimensions are in mm [inch]

Tolerances according to DIN ISO 2768-mH

**Interface**

According to

MIL-STD-348B/310; IEC 61169-15

**Electrical Data**

Impedance	50 Ω
Frequency	DC to 6 GHz
VSWR (Return Loss)	≥ 1.2 (≥ 20.8 dB)
Insertion Loss	≤ 0.04 × √F (GHz) dB
Insulation Resistance	≥ 5 GΩ
Center Contact Resistance	≤ 3 mΩ
Outer Contact Resistance	≤ 2 mΩ
Test Voltage	1000 V rms
Working Voltage	480 V rms
RF leakage	≥ 200 dB @ DC to 2 GHz

**Material And Plating**

Connector parts	Material	Plating
Centre contact	Beryllium Copper	Gold plating, 3 μinch (Non-magnetic nickel-phosphorus underplating, 80 μinch)
Body	Brass	Nickel
Insulator	PTFE	
Coupling nut	Brass	Nickel
Crimp ferrules	Brass	Nickel

**SMA Plug (Male) Connector Bulkhead Crimp Attachment RG-178  
DC-6 GHz VSWR1.2**

**SMA1CA50-G178B / 133**

**Mechanical Data**

Coupling Mechanisms	Screw-Lock
Mating Cycles	≥ 500
Coupling Nut Retention	≥ 270 N
Center contact captivation: axial	≥ 20 N
Coupling Test Torque	≤ 1.7 Nm
Recommended Torque	0.9 Nm
Centre Contact	Soldered
Cable Entry	Crimped

**Environmental Data**

Temperature Range	-55°C to +155°C
Thermal Shock	MIL-STD-202, Method 107, Condition B
Corrosion	MIL-STD-202, Method 101, Condition B
Vibration	MIL-STD-202, Method 204, Condition D
Shock	MIL-STD-202, Method 213, Condition I
Moisture Resistance	MIL-STD-202, Method 106
RoHS	compliant

**Packing**

Single or 100