

SMA Right Angle Cable Plug

SMA1C59-G223A/911

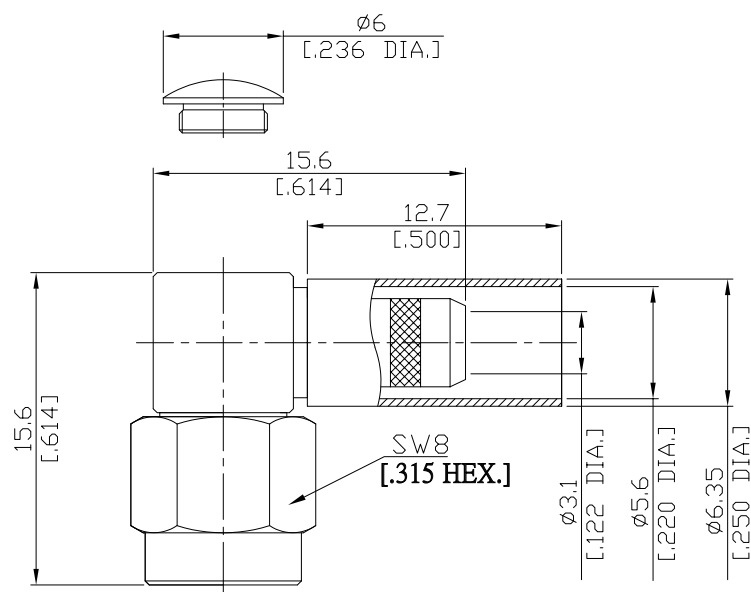

All dimensions are in mm [inch]

Tolerances according to DIN ISO 2768-mH

Interface

According to

IEC 60169-15; MIL-C-39012; MIL-STD-348A/310

Electrical Data

Impedance

 $50\ \Omega$

Frequency

DC to 6 GHz

- Limitations are possible due to the used cable type and manufacturing process -

Mechanical Data

Coupling mechanisms

Screw-lock

Centre contact

Soldered

Cable entry

Crimped

Environmental Data

Temperature range

-65°C to +165°C

RoHS

compliant

Material And Plating

Connector parts	Material	Plating
Centre contact	Beryllium Copper	Gold plating(Nickel underplated)
Body	Brass	Gold plating(Nickel underplated)
Insulator	PTFE	
Gasket	Silicone Rubber	
Coupling nut	Brass	Gold plating(Nickel underplated)
Crimp ferrules	Brass	Gold plating(Nickel underplated)

Suitable Cables

RG 223, RG 55, RG 142, RG 400

Packing

Single, 5-pack, or 100

SMA Right Angle Cable Plug

SMA1C59-G223A/911

Recommended Cable Stripping Dimensions

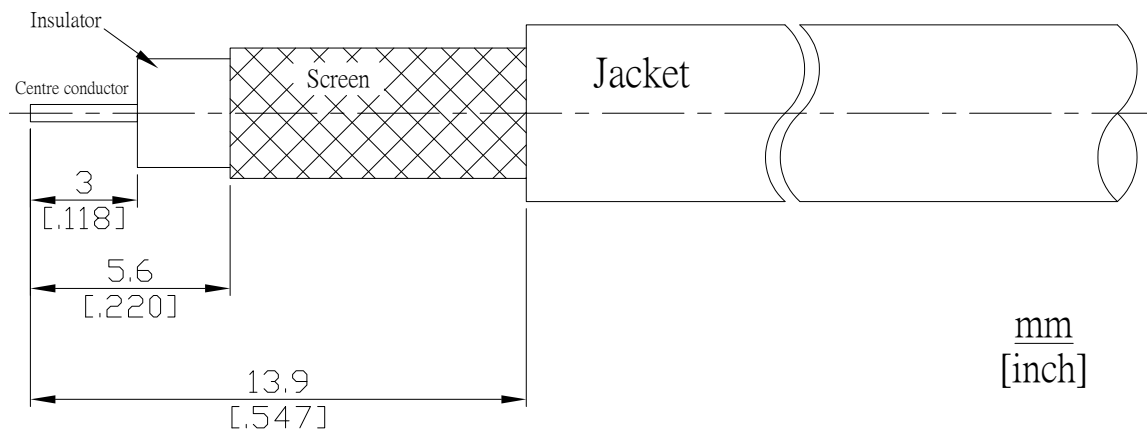

Crimp Dimensions [HEX]

Crimp ferrule

5.41 mm [.213 inch]