

SC Straight Cable Plug

SC1K50-0250A/9XX

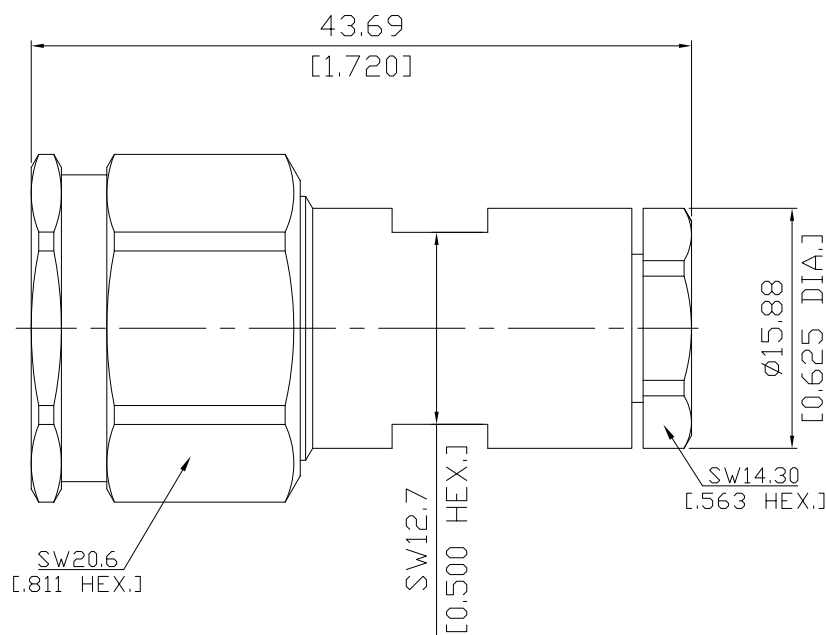

All dimensions are in mm [inch]

Tolerances according to DIN ISO 2768-mH

Interface

According to MIL-C-39012; MIL-STD-348A/309

Electrical Data

Impedance 50 Ω
Frequency DC to 10 GHz
VSWR (Return loss) ≤ 1.20 (≥ 20.83 dB)
Insertion loss ≤ 0.06 x √F (GHz) dB

- Limitations are possible due to the used cable type and manufacturing process -

Mechanical Data

Coupling mechanisms Screw-lock
Centre contact Soldered
Cable entry Solder clamp
Mating cycles ≥ 500

Environmental Data

Temperature range -65°C to +165°C
RoHS compliant
Temperature cycling MIL-STD-202, Meth. 107, Cond. C (-65°C to +165°C)
Shock MIL-STD-202, Meth. 213, Cond. I (100 Gs)
Vibration MIL-STD-202, Meth. 204, Cond. D (20 Gs)
Moisture resistance MIL-STD-202, Meth. 106 (omission of step 7b)
Corrosion MIL-STD-202, Meth. 101, Cond. B (48 hours)
Barometric pressure (altitude) MIL-STD-202, Meth. 105, Cond. C (70000 ft; 625 VRMS)

SC Straight Cable Plug

SC1K50-0250A/9XX

Material And Plating

| Connector parts | Material | Plating |
|-----------------|------------------|----------------------------------|
| Centre contact | Beryllium Copper | Gold plating(Nickel underplated) |
| Body | Stainless Steel | Passivated |
| Insulator | PTFE | |
| Gasket | Silicone Rubber | |
| Coupling nut | Stainless Steel | Passivated |

Suitable Cables

Semi-Rigid .250

Packing

Single or 100