

BNC Right Angle Cable Plug

QPL-BNC1C59-G142A/900

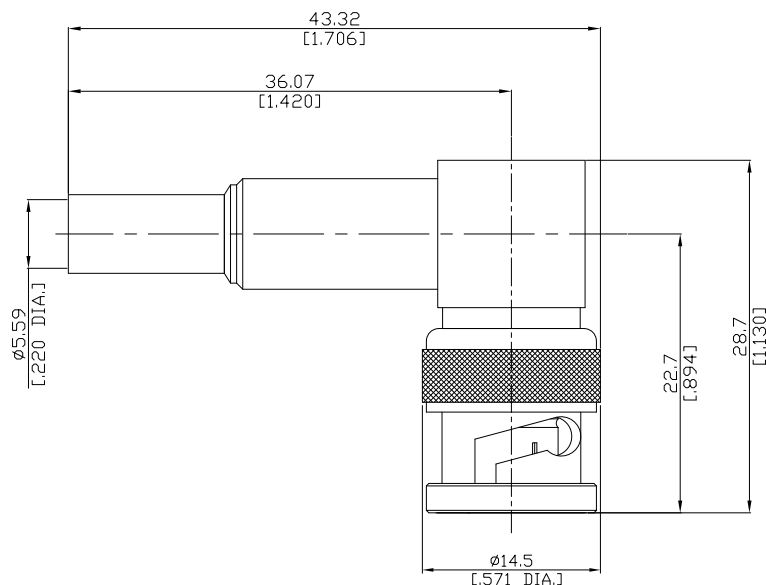

All dimensions are in mm [inch]

Tolerances according to DIN ISO 2768-mH

Interface

According to MIL-C-39012; MIL-STD-348A/301

Electrical Data

Impedance 50 Ω
Frequency DC to 4 GHz
VSWR (Return Loss) ≤ 1.09 (≥ 27 dB), DC to 2 GHz
≤ 1.22 (≥ 20 dB), 2 to 4 GHz
Insertion Loss ≤ 0.05 × √F (GHz) dB

- Limitations are possible due to the used cable type -

Mechanical Data

Coupling mechanisms Bayonet-lock
Centre contact Soldered
Cable entry Crimped

Environmental Data

Temperature range -65°C to +165°C
RoHS compliant

Material And Plating

Connector parts	Material	Plating
Centre contact	Beryllium Copper	Gold plating(Nickel underplated)
Body	Brass	Silver
Insulator	PTFE	
Gasket	Silicone Rubber	
Coupling nut	Brass	Silver
Crimp ferrules	Brass	Silver

Suitable Cables

RG-142B, RG-400U

Packing

Single or 100