

3.5mm Plug (Male) Connector Solder
for RSR085, RSF085, RG405

PC1E50-0085A/9XX

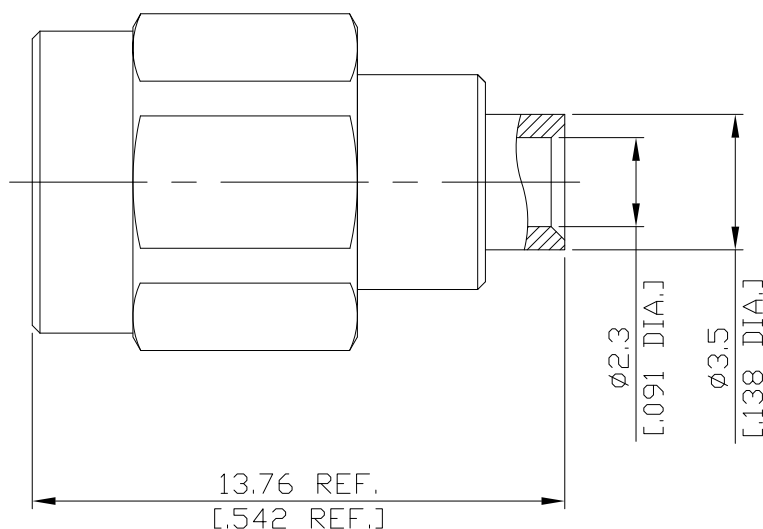

All dimensions are in mm [inch]

Tolerances according to DIN ISO 2768-mH

Interface

According to IEEE std 287; IEC 60169-23

Electrical Data

Impedance 50 Ω
Frequency DC to 33 GHz
VSWR (Return Loss) ≤ 1.20 (≥ 20.83 dB)
Insertion Loss $\leq 0.04 \times \sqrt{F}$ (GHz) dB

- Digressions are possible due to the used cable type and manufacturing process -

Mechanical Data

Coupling mechanisms Screw-lock
Centre contact Plug-in
Cable entry Soldered

Environmental Data

Temperature range -65°C to +165°C
RoHS compliant

Material And Plating

| Connector parts | Material | Plating |
|-----------------|------------------|----------------------------------|
| Centre contact | Beryllium Copper | Gold plating(Nickel underplated) |
| Body | Stainless Steel | Passivated |
| Insulator | PS | |
| Coupling nut | Stainless Steel | Passivated |

Suitable Cables

RSR085, RSF085, RG405

Packing

Single or 100