

NEX10 Plug Male Connector Solder/Solder
Attachment for LMR400, RNL400 DC-8GHz VSWR1.20

NEX101E50-EZR400A / 144

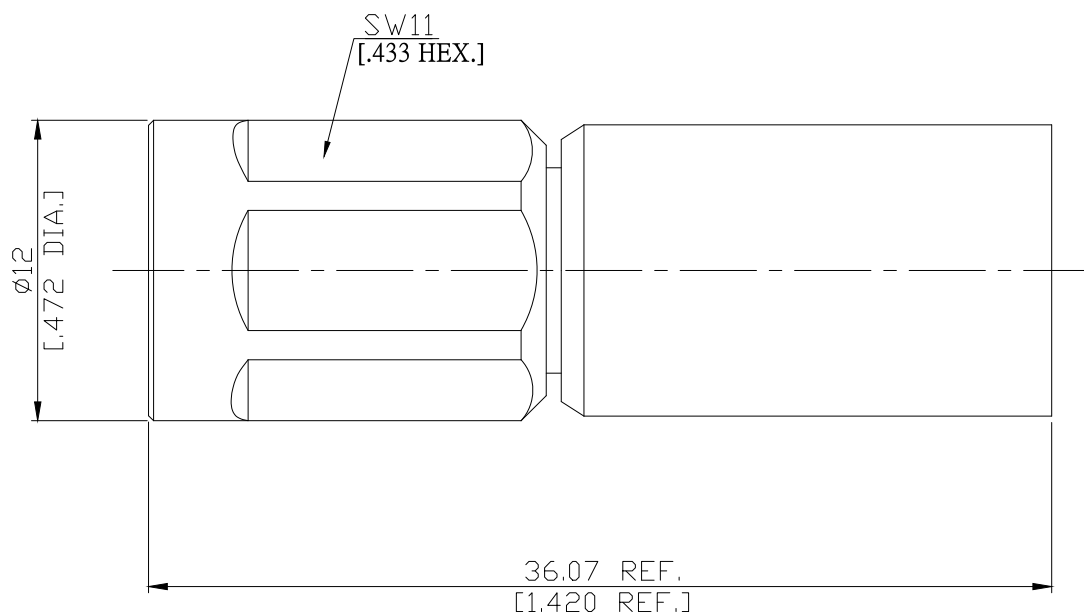

All dimensions are in mm [inch]

Tolerances according to DIN ISO 2768-mH

Interface

According to NEX10® / IEC tbd

Electrical Data

Impedance	50 Ω
Frequency	DC to 8 GHz
VSWR (Return Loss)	≤ 1.20 (≥ 20.83 dB)
Insertion Loss	≤ 0.05 x √F (GHz) dB
Insulation Resistance	≥ 5 GΩ
Center Contact Resistance	≤ 1.5 mΩ
Outer Contact Resistance	≤ 1.5 mΩ
Test Voltage	1000 V rms
Working Voltage (at sea level)	500 V rms
Power Handling (at 20 °C, sea level, VSWR 1.0)	≤ 100 W @ 2 GHz in 85°C

Material And Plating

Connector parts	Material	Plating
Centre contact	Brass	Gold plating, 5 μinch (Non-magnetic nickel-phosphorus underplating, 80 μinch)
Body	Brass	Copper-Tin-Zinc Alloy
Insulator	PTFE	
Coupling Nut	Brass	Copper-Tin-Zinc Alloy
Crimp ferrule	Brass	Copper-Tin-Zinc Alloy

NEX10 Plug Male Connector Solder/Solder
Attachment for LMR400, RNL400 DC-8GHz VSWR1.20

NEX101E50-EZR400A / 144

Mechanical Data

Coupling mechanisms	Screw-lock
Mating Cycles	min. 100
Coupling nut retention	≥ 500 N
Centre Contact	Soldered
Cable Entry	Soldered
Recommended Torque	5 Nm
Center contact retention force	1 - 10 N
Outer contact retention force	3 - 20 N

Environmental Data

Temperature Range	-65°C to +125°C
Thermal shock	IEC 61169-1 9.4.4
Vibration	IEC 61169-1 9.3.3 and IEC 60068-2-64
Shock	IEC 61169-1 9.3.14
Degree of protection (mated pair)	IEC 60529, IP68 24h / 1m
RoHS	compliant

Packing

Single or 100